

Film Feeder Move Unit

Part Number/Price

REF #	PART #	DESCRIPTION	QTY	SYNONYM	PRICE
1	Consult	Bracket, sensor, lift	1	000-135-0430-33	Consult
2	Consult	Shaft, link, feeder move front	2	000-135-0384-08	Consult
3	Consult	Bracket, sensor, original point	1	000-135-0418-01	Consult
4	Consult	Shaft, feeder move rear	1	000-124-5864-10	Consult
5	Consult	Bracket, motor, feeder move front	1	000-145-9915-07	Consult
6	189247	Link, feeder move front	1	000-135-0381-07	Consult
7	189248	Link, feeder move front	1	000-135-0382-01	Consult
8	Consult	L plate B, feeder move front	1	000-135-0431-37	Consult
9	Consult	Bracket, motor, feeder move	1	000-135-0428-35	Consult
10	Consult	Frame, feeder move, front	1	000-135-0415-55	Consult
11	Consult	Frame, feeder move, L	1	000-135-0368-44	Consult
12	Consult	Frame, feeder move, R	1	000-135-0378-33	Consult
13	Consult	Frame, feeder move, R	1	000-135-0416-21	Consult
14	Consult	Guide, harness	1	000-135-0379-27	Consult
15	Consult	Bracket, tension	1	000-135-0376-26	Consult
16	Consult	Bracket, tension	1	000-135-0377-20	Consult
17	Consult	Bracket, connector, front	1	000-135-0371-46	Consult
18	189249	Bracket, connector, rear	1	000-135-0374-48	Consult
19	Consult	Frame, feeder drive, rear	1	000-135-0427-41	Consult
20	189111	Rubber pad	2	000-039-8056-01	Consult
21	172546	Housing, feeder move, front	2	000-111-8471-01	Consult
22	172547	Housing, feeder move, back	2	000-111-8472-04	Consult
23	172548	Bearing, linear bush	8	000-068-5133-03	Consult
—	200474	Screw, tapping M5 x 8 mm, phillips flange head T2	8	000-051-5470-09	Consult
24	106115	Bearing, radial, deep groove	4	000-030-6366-02	Consult
25	172549	Gear, flat	2	000-111-8469-02	Consult
26	Consult	Shaft, feeder move	1	000-109-5560-25	Consult
27	Consult	Pin, parallel	2	000-040-9790-09	Consult
28	Consult	Collar	2	000-112-6883-01	Consult
29	193549	Shaft, linear	2	000-106-6952-32	Consult
30	Consult	Gear, flat	1	000-111-8382-02	Consult
31	172550	Timing pulley, S5M, AF	3	000-073-7226-06	Consult
32	Consult	Shaft, fulcrum, rear	2	000-106-6950-26	Consult
33	172516	Timing pulley, S5M, AF	2	000-111-8392-00	Consult
34	192314	Shaft, pulley, tension	2	000-137-8020-06	Consult
35	88649	Pulley, tension	2	000-048-3915-03	Consult
36	Consult	Guide, harness	1	000-130-6968-35	Consult
37	Consult	Timing pulley, S5M	2	000-117-3042-01	Consult
38	Consult	Flange, feeder move	4	000-090-0783-05	Consult
39	Consult	Timing pulley, S5M, AF	1	000-073-7225-02	Consult
40	Consult	Bracket, motor, feeder move	1	000-131-1766-01	Consult
41	172551	Bearing unit, flange	2	000-109-8054-19	Consult
42	201442	Shaft, drive feeder	1	000-106-6951-66	Consult
43	201443	Timing pulley, S5M, AF	1	000-112-9511-07	Consult
44	201444	Timing pulley, S5M, AF gear	1	000-111-8383-06	Consult
45	189250	Key, parallel, both ends round	1	000-119-7910-03	Consult
46	172552	Timing belt, HPS5M	2	000-109-8057-10	Consult
47	172554	Timing belt, HPS5M	1	000-109-8058-13	Consult
48	172555	Timing belt, HPS5M	1	000-109-8056-16	Consult
49	172556	Reflector	1	000-073-7263-04	Consult
50	172557	Gear head, rear move shaft	1	000-055-9082-01	Consult
51	172558	Gear head, feeder drive shaft	1	000-056-2722-02	Consult
52	172533	Timing belt, HPS5M	2	000-131-1761-03	Consult
53	Consult	Holder, timing belt, rear	2	000-138-5654-03	Consult
54	188328	Motor assy, stepping, front film feeder move, M121	1	000-111-8422-08	Consult
55	175122	Motor, DC, brushless, feeder drive, M09	1	000-135-2938-08	Consult
56	188330	Motor, DC, brushless with brake, rear film feeder move, M05	1	000-135-2939-01	Consult

Film Feeder Move Unit

Part Number/Price

REF #	PART #	DESCRIPTION	QTY	SYNONYM	PRICE
57	Consult	Plate A, spacer	2	000-145-8388-01	Consult
58	189251	Bracket, reflector	1	000-146-5211-11	Consult
59	Consult	Frame, film width	1	000-135-0330-54	Consult
60	189252	Detect plate, feeder move	1	000-139-9370-18	Consult
61	Consult	Cap, harness, switch	1	000-091-0707-09	Consult
62	189253	L plate B, detecting plate	1	100-002-0735-00	Consult
501	157857	Sensor assy, lift, tray detect, B206	1	000-072-2231-28	Consult
502	171837	Photo interrupter, sensor, transmitter, straight connector, B213	1	000-132-6468-07	Consult
503	104239	Photo interrupter, transmitter, white conn., B212, B217-B218	3	000-070-5204-14	Consult
504	125711	Photo interrupter, sensor, transmitter, B215T, B216T (Note: transmit sensor does not include item #509 189254 sheet, sensor	2	000-112-9768-07	Consult
505	125712	Photo interrupter, sensor, receiver, B215, B216	2	000-112-9769-01	Consult
506	Consult	Accessory band, marking tie	1	000-135-2735-09	Consult
507	Consult	Accessory band, marking tie	1	000-135-2736-02	Consult
508	157866	Switch safety, film over door, S200	1	000-111-8428-00	Consult
509	189254	Sheet, sensor	2	000-095-4038-04	Consult
601	189255	Harness, C6, feeder move	1	100-000-7012-00	Consult
602	172559	Harness, C17, feeder move	1	100-001-2953-00	Consult
603	203535	Harness, C8, sensor	1	000-135-2786-27	Consult
604	203536	Harness, C5, SW	1	000-137-8142-25	Consult
ASSY	201989	Kit, photo interrupters and sensor sheet, one each of 125711, 125712 and 189254			Consult

Ishida WM-Ai

Film Feeder Move Unit

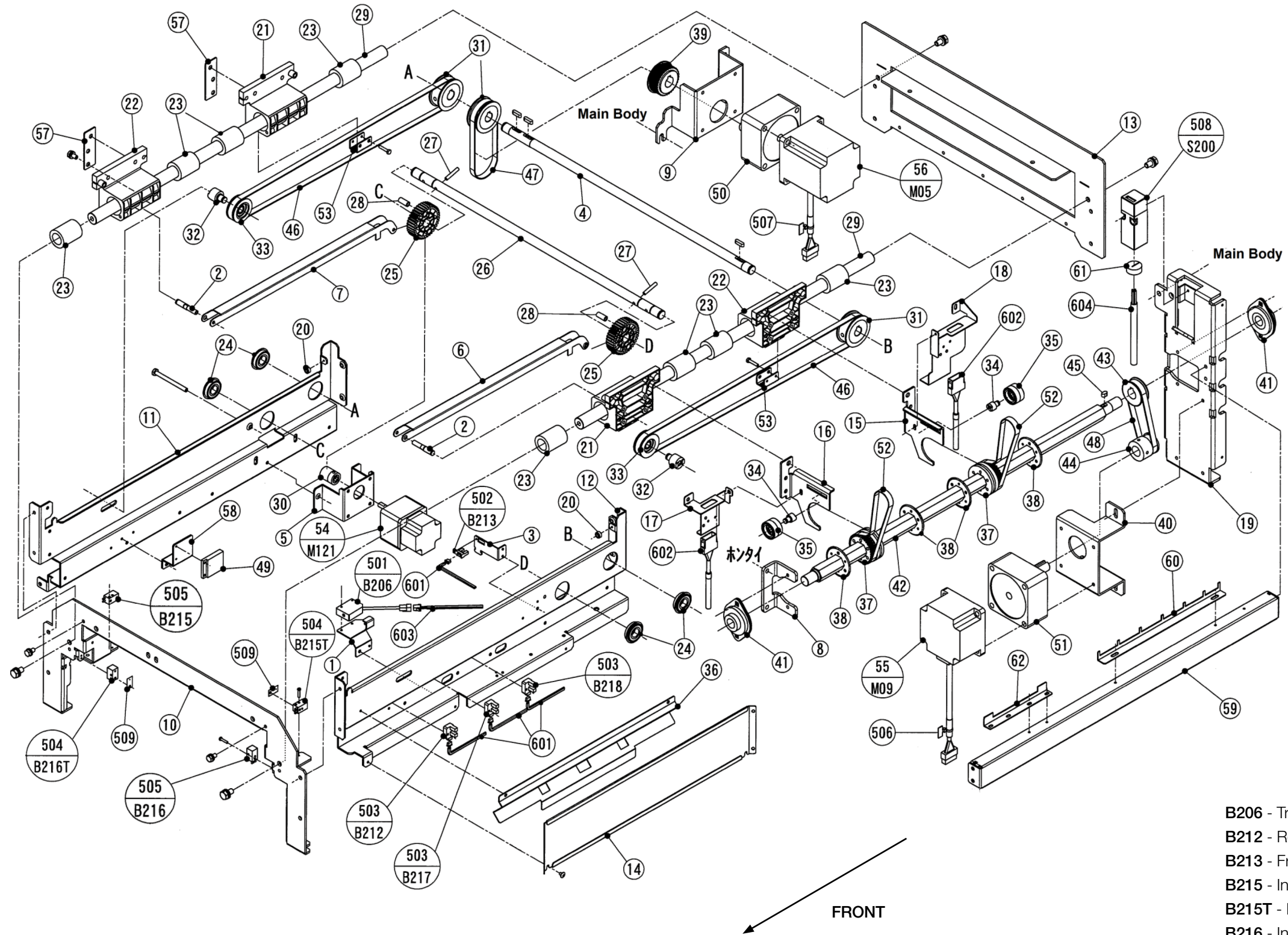

- B206 - Tray on lift detect
- B212 - Rear film feeder, home position
- B213 - Front film feeder, home position
- B215 - Infeed safety, front left, receiver
- B215T - Infeed safety, front right, transmitter
- B216 - Infeed safety, rear right, receiver
- B216T - Infeed safety, rear left, transmitter
- B217 - Rear film feeder, small lift clearance
- B218 - Rear film feeder, large lift clearance