

# RL-HPJ Hand Pallet Jack Scale

## Assembly Procedure

After unpacking, visually inspect to ensure all of the components are included and undamaged. If any parts were damaged in shipment, notify Rice Lake Weighing Systems and the shipper immediately.

For additional information, see RL-HPJ Hand Pallet Jack Scale Technical Manual (PN 183812).

### Recommended Tools (Not Provided)

- 2.5 mm hex key
- 8 mm hex key
- Pliers

### Indicator Stand Assembly

1. Cut the red zip tie holding the wire sleeve to the pallet jack chassis.
2. Place the indicator stand on the fork assembly, being careful not to pull or pinch the load cell wires (Figure 1–A).

*\*The load cells of the pallet jack come wired to the indicator*

3. Make sure the stand is properly supported and seated correctly.
4. Feed excess wire sleeve up into the indicator stand.
5. Remove the four screws that secure the front plate to the indicator stand using a 2.5 mm hex key (Figure 1–B).
6. Secure indicator stand with four M10 x 15 mm screws and M10 washers using an 8 mm hex key (Figure 1–C).
7. Reattach the front plate to the indicator stand, using the four previously removed screws (Figure 1–D).

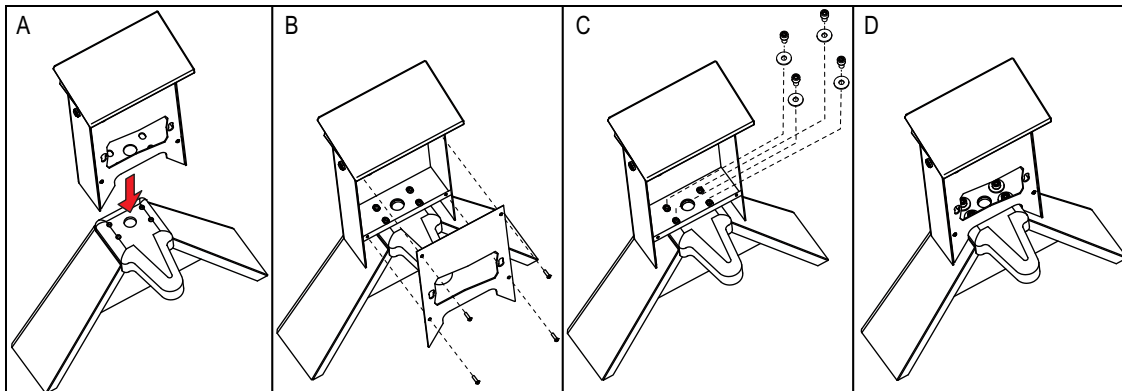

Figure 1. Indicator Stand Assembly

### Battery Installation

1. Connect the wire connector inside the column to the battery.
2. Slide the battery into the indicator stand at a slight angle and turn counterclockwise to lock it in place.

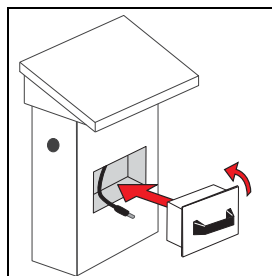

Figure 2. Battery Installation

## Handlebar Assembly

1. Insert a cotter key pin into the hole on one end of the pivot pin (Figure 3-A).
2. Lower the base of the handlebar into the steering column of the fork assembly (Figure 3-B).
3. Slide pivot pin through mounting holes of the steering column and mounting holes of the handlebar (Figure 3-B). Pivot pin must be inserted so the cotter key slides into the groove of the steering column mounting hole (Figure 3-C).
4. Direct the handlebar chain into the handlebar and through the center hole in the pivot pin (Figure 3-B2).

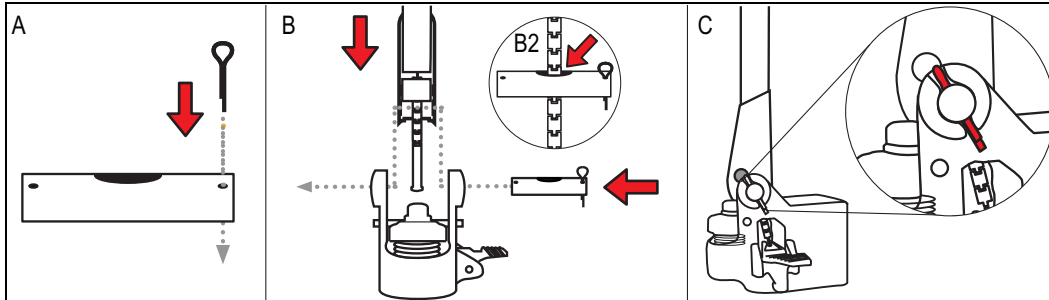

Figure 3. Handlebar Attachment

5. Insert the second cotter key into the hole on the opposite end of the pivot pin (Figure 4-A).
6. Push down on the steering column lever and hold down to assist in joining the handlebar chain with the lifting connection lever. Navigate the end of the chain into the groove in the lifting connection lever. Ensure the bottom catch of the chain is below the lever and seated completely into the groove for a good connection (Figure 4-B).
7. Release the steering column lever, further engaging the handlebar chain with the connection lever (Figure 4-C).

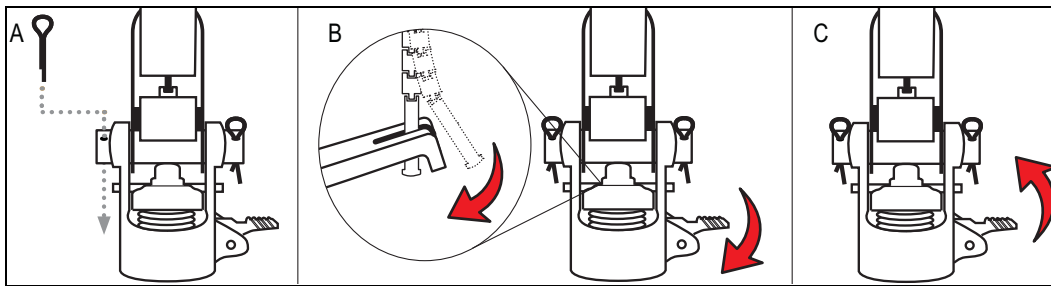

Figure 4. Connecting the Handlebar Chain

8. Lower the handlebar and hold down to maintain pressure on the lift pump (Figure 5-A).
9. Remove retainer pin locking down the lift pump from the steering column (Figure 5-B).
10. Return the handlebar back to the upright position (Figure 5-C).

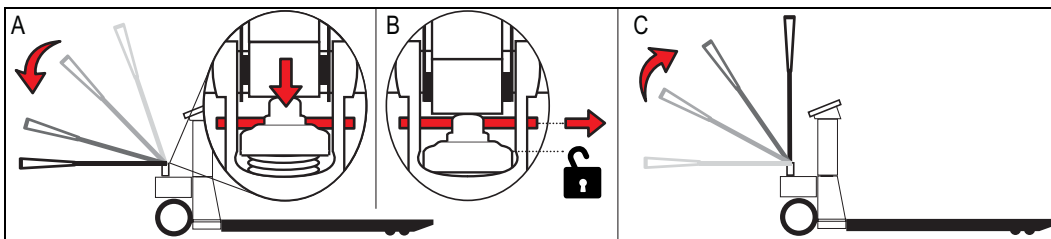

Figure 5. Unlocking the Lift Pump

**RICE LAKE**<sup>®</sup>  
WEIGHING SYSTEMS

© Rice Lake Weighing Systems Specifications subject to change without notice.  
Rice Lake Weighing Systems is an ISO 9001 registered company.

230 W. Coleman St. • Rice Lake, WI 54868 • USA  
U.S. 800-472-6703 • Canada/Mexico 800-321-6703 • International 715-234-9171 • Europe +31 (0)26 472 1319