

WMC Miniature Sealed

Stainless Steel



Picture is a representation of actual product

Order Information

Load Rating	Part #	Est. Weight	Price
5 lb	185090	1 lb	Consult
10 lb	185091	1 lb	Consult
25 lb	185092	1 lb	Consult
50 lb	185093	1 lb	Consult
100 lb	185094	1 lb	Consult
250 lb	185095	1 lb	Consult
500 lb	185096	1 lb	Consult
1,000 lb	185084	1 lb	Consult
2,000 lb	185085	1 lb	Consult
3,000 lb	185086	1 lb	Consult
5,000 lb	185087	1 lb	Consult
7,500 lb	185088	1 lb	Consult
10,000 lb	185089	1 lb	Consult

Dimensions

Rated Capacity	A	B	C	D	E	F	G	H
lb/in								
5 to 10	0.45	0.06	0.75	0.25	6-32 UNC	0.50	0.39	1.01
25 to 100	0.52	0.03	1.00	0.25	10-32 UNF	0.50	0.39	1.05
250 to 500	0.53	0.03	1.00	0.38	1/4-28 UNF	0.50	0.39	1.32
1,000	0.53	0.03	1.00	0.38	0.25-28 UNF	0.50	0.39	1.32
2,000 to 3,000	0.72	0.03	1.00	0.50	0.38-24 UNF	0.50	0.39	1.75
5,000	0.94	0.03	1.25	0.63	0.50-20 UNF	0.50	0.39	2.23
7,500 to 10,000	1.09	0.03	1.38	0.88	0.75-16 UNF	0.50	0.39	2.88

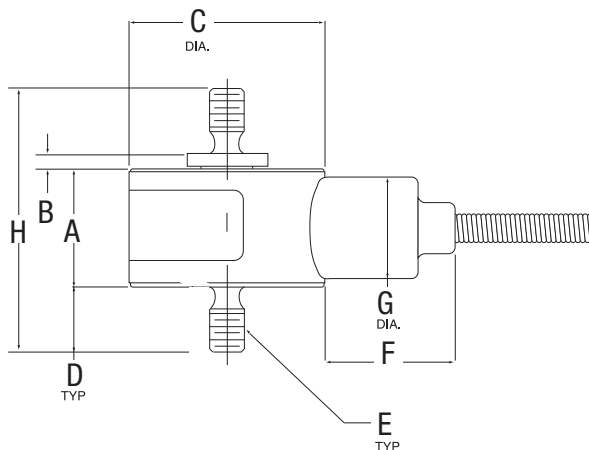

Specifications

- Full Scale Output:**
2.0 mV/V
- Bridge Resistance:**
350 ohm nominal
- Material/Finish:**
Stainless steel
- Temperature:**
Operating:
-65 °F to 250 °F (-54 °C to 121 °C)
- Safe Overload:**
150% full scale
- Rated Excitation:**
12 VDC
- Nonlinearity:**
5 to 500 lb: ± 0.15% full scale
1,000 to 10,000 lb: ± 0.20% full scale
- Hysteresis:**
5 to 500 lb: ± 0.15% full scale
1,000 to 10,000 lb: ± 0.20% full scale
- Insulation Resistance:**
> 5,000 megohm
- Cable Length:**
5 ft
- Cable Color Code:**
Red +Excitation
Black -Excitation
White +Signal
Green -Signal
- Warranty:**
One-year limited

INTERFACE®