

SINGLE-ENDED BEAM  
**RL30002 Thru Hole**

Alloy Steel, Environmentally Sealed, NTEP Certified 1:5,000 III L Class III Multiple Cell, IP67



Picture is a representation of actual product.

**Approvals**



**Order Information**

Load Rating	Part #	Est. Weight	Price
<b>NTEP Certified</b>			
1,000 lb	21521	3 lb	Consult
2,000 lb	21522	3 lb	Consult
2,500 lb	21523	3 lb	Consult
4,000 lb	21524	3 lb	Consult
5,000 lb SE	21525	3 lb	Consult
<b>Conduit Adapter Kit (must be factory installed to maintain warranty)</b>			
3/8-24 nipple	31533*	1 lb	Consult
3/8-24 to 1/4-18 NPT	31534*	1 lb	Consult

SE=small envelope

\* PN 31533 and PN 31534 must be installed together to form the Conduit Adapter Kit

**Dimensions**

Rated Capacity	A3	B	C	D	E	F	G	H
lb/in								
1,000 to 5,000 SE	0.53	5.12	1.25	1.25	0.62	1.00	3.00	0.50

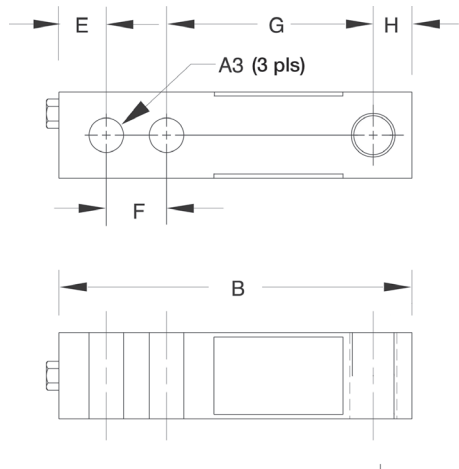

**Interchangeable Products**

VPG® TEDEA-HUNTLEIGH®  
**3410**  
 ARTECH®  
**30210**

**Specifications**

**Full Scale Output:**  
 3.0 mV/V

**Bridge Resistance:**  
 350 ohm, nominal

**Material/Finish:**  
 High-alloy steel, nickel plated

**Temperature:**  
 Compensated:  
 14 °F to 104 °F (-10 °C to 40 °C)  
 Operating:  
 0 °F to 150 °F (-18 °C to 65 °C)

**Seal Type:**  
 Environmentally sealed, IP67

**Safe Overload:**  
 150% full scale

**Safe Sideload:**  
 100% full scale

**Rated Excitation:**  
 5 to 10 VDC (15 V maximum)

**Combined Error:**  
 0.02% full scale

**Insulation Resistance:**  
 5,000 megohm

**Deflection at Capacity:**  
 1,000 lb: 0.013 in  
 2,000 to 3,000 lb: 0.015 in  
 4,000 to 5,000 lb: 0.025 in

**Cable Length:**  
 20 ft

**Cable Diameter:**  
 0.200 in  
 Polyurethane jacket

**Cable Color Code:**  
 Red +Excitation  
 Black -Excitation  
 Green +Signal  
 White -Signal

**Warranty:**  
 Two-year limited

**Approvals:**  
 cFMus  
 NTEP 98-043

**RICE LAKE  
 LOAD CELLS**