



Picture is a representation of actual product

Approvals



Order Information

Load Rating	Part #	Est. Weight	Price
NTEP Certified			
500 lb	36272	3 lb	Consult
750 lb	36273	3 lb	Consult
1,000 lb	36274	3 lb	Consult
1,500 lb	36275	3 lb	Consult
2,000 lb	36276	3 lb	Consult
2,500 lb	36277	3 lb	Consult
3,000 lb	36278	3 lb	Consult
5,000 lb	36279	4 lb	Consult
Non-NTEP Certified			
10,000 lb	36280	4 lb	Consult

Dimensions

Rated Capacity	A	B	D	E
lb/in				
500 to 3,000	1/2-20 UNF	1.00	2.00	3.00
5,000 to 10,000	3/4-16 UNF	1.00	3.50	4.75

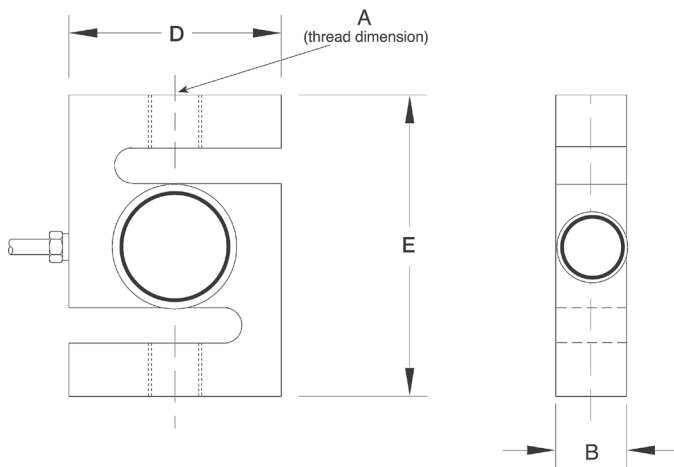

Interchangeable Products

RICE LAKE WEIGHING SYSTEMS
RL20001HE.....page 100

Weigh Module Available

RICE LAKE WEIGHING SYSTEMS
ITCM Isolated Tension
Cell Mount..... page 38

Specifications

Full Scale Output:

2.0 mV/V

Output Resistance:

349 to 355 ohm

Input Resistance:

349 to 350 ohm

Material/Finish:

Stainless steel

Temperature:

Compensated:

14 °F to 104 °F (-10 °C to 40 °C)

Operating:

0 °F to 150 °F (-18 °C to 65 °C)

Seal Type:

Welded-seal, IP68

Safe Overload:

150% full scale

Rated Excitation:

5 to 10 VDC (15 V maximum)

Combined Error:

0.03% full scale

Insulation Resistance:

5,000 megohm

Cable Length:

20 ft

Cable Diameter:

0.200 in

Polyurethane jacket

Cable Color Code:

Red +Excitation

Black -Excitation

Green +Signal

White -Signal

Warranty:

One-year limited

Approvals:

cFMus

NTEP