



Picture is a representation of actual product.

Approvals



Order Information

Load Rating	Part #	Est. Weight	Price
5,000 lb	194021	5 lb	Consult
10,000 lb	194022	5 lb	Consult
20,000 lb	194023	5 lb	Consult
30,000 lb	194024	20 lb	Consult
40,000 lb	194025	20 lb	Consult
50,000 lb	194026	20 lb	Consult
60,000 lb	194027	20 lb	Consult

Dimensions

Rated Capacity lb/in	A	B	C	D	E	F	ØG	H
5,000 to 20,000	8.12	1.14	6.88	1.44	1.71	1.71	1.00	1/4-18 NPT
30,000 to 60,000	10.25	2.38	8.50	1.88	3.03	3.03	2.00	1/2-14 NPT

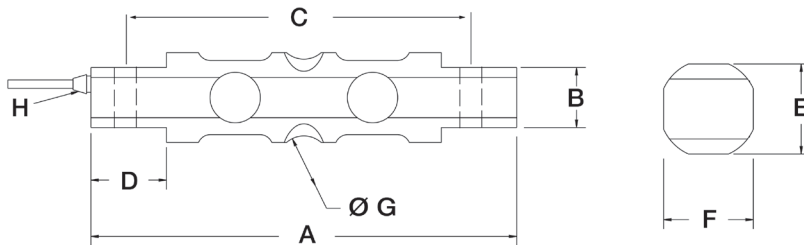

Interchangeable Products

VPG® REVERE
9103..... page 256

Weigh Module Available

RICE LAKE WEIGHING SYSTEMS
EZ Mount 1 HE..... page 69

Specifications

- Full Scale Output:**
3.0 mV/V
- Output Resistance:**
700 (± 5) ohm
- Input Resistance:**
800 (± 30) ohm
- Material/Finish:**
Stainless steel
- Temperature:**
Operating:
0 °F to 150 °F (-18 °C to 65 °C)
- Seal Type:**
Welded-seal, IP68
- Safe Overload:**
150% full scale
- Rated Excitation:**
5 to 10 VDC
- Nonlinearity:**
0.03% full scale
- Hysteresis:**
0.5% full scale
- Insulation Resistance:**
5,000 megohm
- Cable Length:**
25 ft
- Cable Color Code:**
Red +Excitation
Black -Excitation
Green +Signal
White -Signal
- Warranty:**
Two-year limited
- Approvals:**
cFMus
NTEP 21-064

**RICE LAKE
LOAD CELLS**