

RL20001HE

Stainless Steel, Welded Seal, NTEP Certified 1:5,000 Class III/1:10,000 Class IIII Single Cell, IP68



Picture is a representation of actual product.

Approvals



Order Information

Load Rating	Part #	Est. Weight	Price
NTEP Certified			
500 lb	46469	2 lb	Consult
750 lb	46470	2 lb	Consult
1,000 lb	46471	2 lb	Consult
1,500 lb	46472	2 lb	Consult
2,000 lb	46473	2 lb	Consult
2,500 lb	46474	2 lb	Consult
3,000 lb	46475	2 lb	Consult
5,000 lb	46476	5 lb	Consult
Non-NTEP Certified			
10,000 lb	36292	5 lb	Consult

Dimensions

Rated Capacity	A	B	D	E
lb/in				
500 to 3,000	1/2-20 UNF	1.00	2.00	3.00
5,000 to 10,000	3/4-16 UNF	1.00	3.50	4.75

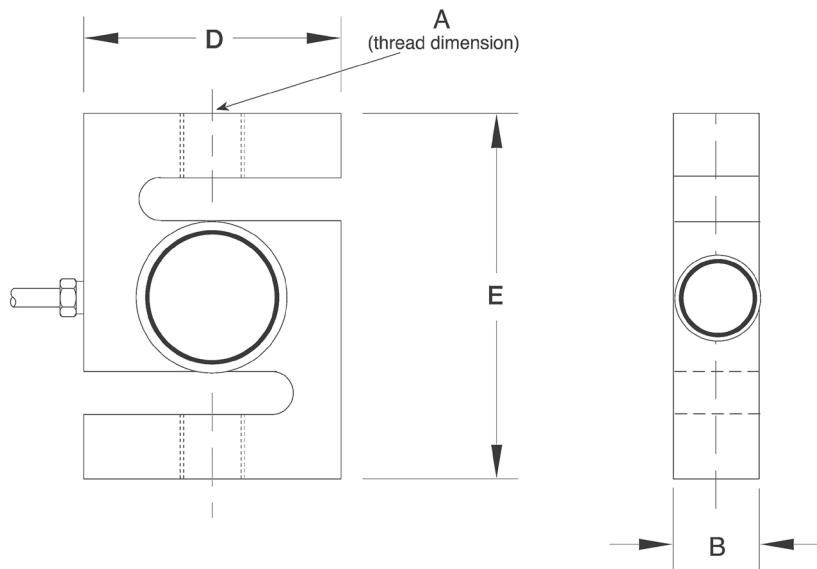

Interchangeable Products

VPG® SENSORTRONICS®
60063page 277

Weigh Module Available

RICE LAKE WEIGHING SYSTEMS
ITCM HE Isolated Tension Cell Mount..... page 40

Specifications

- Full Scale Output:**
2.0 mV/V
- Bridge Resistance:**
350 ohm, nominal
- Material/Finish:**
Stainless steel
- Temperature:**
Compensated:
14 °F to 104 °F (-10 °C to 40 °C)
Operating:
0 °F to 150 °F (-18 °C to 65 °C)
- Seal Type:**
Welded-seal, IP68
- Safe Overload:**
150% full scale
- Rated Excitation:**
5 to 10 VDC (15 V maximum)
- Combined Error:**
0.02% full scale
- Insulation Resistance:**
5,000 megohm
- Cable Length:**
20 ft
- Cable Diameter:**
0.200 in
Polyurethane jacket
- Cable Color Code:**
Red +Excitation
Black -Excitation
Green +Signal
White -Signal
- Warranty:**
Two-year limited
- Approvals:**
cFMus
NTEP 98-071

RICE LAKE
LOAD CELLS