

INDICATORS

# 920i® Panel Mount Indicator/Controller

Main Assembly



## Part Number/Price

Ref#	Part#	Description	Price
	<b>71428</b>	Parts kit panel mount single channel	Consult
	<b>71429</b>	Parts kit panel mount dual channel	Consult
<b>Components of Part #71428</b>			
	<b>14626</b>	Nut, KEP, 8 - 32 NC	Consult
	<b>54206</b>	Machine screws, 6 - 32 x 3/8 fillister head	Consult
	<b>15133</b>	Lock washers, no. 8, Type A	Consult
	<b>71522</b>	Machine screws, 8 - 32 NC x 1/4	Consult
	<b>82425</b>	Machine screws, 10 - 32 NF x 1.5 in	Consult
	<b>15631</b>	Cable ties	Consult
	<b>53075</b>	Cable shield ground clamps	Consult
	<b>94422</b>	Capacity label	Consult
	<b>77180</b>	8-position screw terminals for J10 (Rev. H CPU)	Consult
	<b>70599</b>	6-position screw terminals for J2	Consult
	<b>15887</b>	6-position screw terminals for load cell connection	Consult
	<b>71126</b>	4-position screw terminal for J9	Consult
	<b>71125</b>	3-position screw terminal for J11	Consult
	<b>15438</b>	Power cord, 115VAC and 230VAC North American units	Consult
	<b>72512</b>	Power cord, 230VAC European units	Consult
	<b>67887</b>	Installation manual	Consult
	<b>69989</b>	Panel mount installation instructions	Consult
1	<b>14618</b>	Nut, KEP, 4 - 40 NC	Consult
2	<b>14626</b>	Nut, KEP, 8 - 32 NC	Consult
3	<b>15601</b>	Ground wire, 6" with no. 8 eye connector	Consult
4	<b>14822</b>	Machine screws, 4 - 40 NC x 1/4	Consult
5	<b>71450</b>	AC input assembly	Consult
	<b>97907</b>	AC input cable assembly	Consult
6	<b>15134</b>	Lock washers, no. 8, Type A	Consult
7	<b>22917</b>	Washer, Lock no 4, type A	Consult
8	<b>16861</b>	Label, warning high	Consult
9	<b>16892</b>	Ground/earth label	Consult
10	<b>14839</b>	Machine screws, 6 - 32 NC x 1/4	Consult
11	<b>66502</b>	Overlay, membrane switch	Consult
12	<b>67610</b>	Single channel A/D card	Consult
	<b>68532</b>	Single-channel A/D card	Consult
	<b>68533</b>	Dual-channel A/D card	Consult
	<b>67600</b>	Memory, 1 MB NV RAM option	Consult
	<b>67601</b>	Digital I/O, 24-channel option	Consult
	<b>67602</b>	Analog output: selectable 0-10V, 0-20 mA option	Consult
	<b>103138</b>	Analog output, dual channel 0-10VDC 0-20 mA option	Consult
	<b>67604</b>	Serial, dual channel option	Consult
	<b>67603</b>	Pulse input, single channel option	Consult
	<b>68541</b>	DeviceNet™ interface option	Consult
	<b>68539</b>	Allen-Bradley® Remote I/O interface option	Consult
	<b>68540</b>	Profibus® DP interface option	Consult
	<b>103136</b>	Control net interface option	Consult
	<b>71986</b>	Ethernet TCP/IP 10/100 Base-T module (internal) option	Consult
	<b>87697</b>	Analog input and thermocouple	Consult
	<b>87803</b>	EtherNet/IP (for A-B PLC)	Consult
	<b>71743</b>	Option, 2-Slot Expansion Board, (Panel & Deep)	Consult
13	<b>117930</b>	CPU board green solder mask	Consult
	<b>186272</b>	CPU board blue solder mask	Consult
14	<b>69141</b>	Fuse access coverplate	Consult
15	<b>164371</b>	LCD display transmissive (indoor use) CCFL B/L	Consult
	<b>186275</b>	LCD display transmissive (indoor use) with LED B/L	Consult
	<b>186276</b>	LCD display transreflective (outdoor use) with LED B/L	Consult
	<b>159946</b>	CCFL backlight for display (type WRUS)	Consult
	<b>187677</b>	LED backlight for display (type WRUS, IQSS, ZARS)	Consult
16	<b>69142</b>	Housing backplate	Consult
17	<b>67869</b>	Interface board PS2/DB-9	Consult
	<b>111109</b>	Interface board USB (requires Rev. L CPU)	Consult
18	<b>67886</b>	Standoffs, short	Consult

(See Diagram 920i-G)

Indicators/Controllers

# 920i® Panel Mount Indicator/Controller

Main Assembly

## Part Number/Price

Ref#	Part#	Description	Price
19	68216	Nameplate, Rice Lake	Consult
20	68598	Protective lens	Consult
21	71106	Enclosure, wldt	Consult
22	68661	Standoffs, long	Consult
23	69290	3V Lithium coin battery	Consult
25	69144	Gasket, faceplate	Consult
26	69176	Power supply bracket	Consult
27	71449	Ribbon cable to interface board	Consult
28	132791	Power supply, 12-24VDC, 25W	Consult
29	15631	Cable tie, 3 in nylon	Consult
30	71430	Wire harness, 65W ps	Consult
34	71698	Strip, polyurethane foam	Consult
35	71520	Screw, mach 10-32 NF 3/16	Consult
36	87608	Reinforcing plate	Consult
37	71095	Bracket, clinching welded	Consult

(See Diagram 920i-G)



INDICATORS

# 920i® Panel Mount Indicator/Controller

## Main Assembly

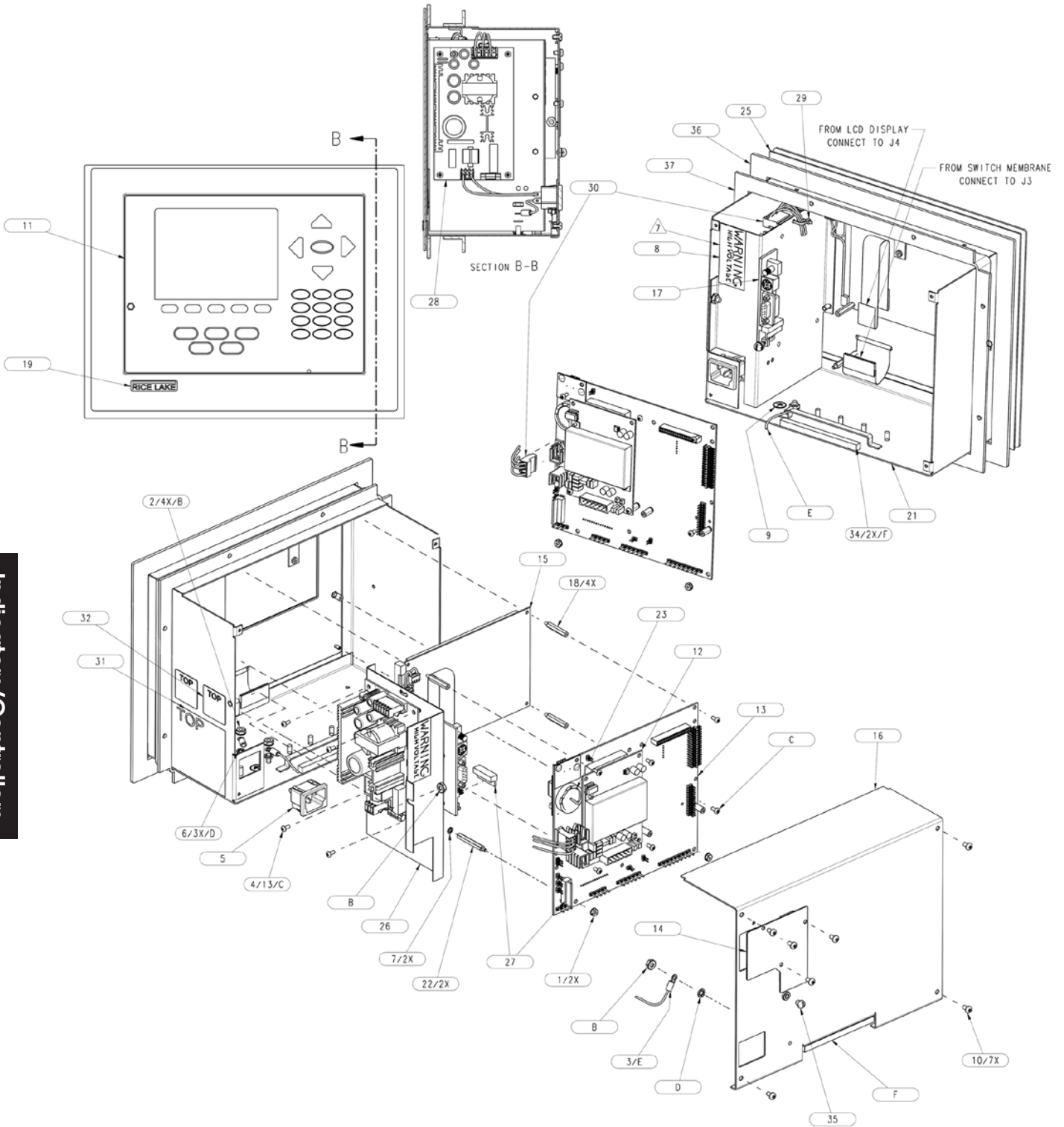

920i-G