

INDICATORS

920i® Universal Indicator/Controller

Main Assembly



Part Number/Price

Ref#	Part#	Description	Price
	126303	Parts kit universal dual channel	Consult
	126285	Parts kit universal single channel	Consult
Components of Part # 126303 and 126285			
	14626	Nut, KEP, 8 - 32 NC	Consult
	14862	Machine screws, 8-32 NC x 3/8	Consult
	75062	Sealing washers	Consult
	15133	Lock washers, no. 8, type A	Consult
	30623	Machine screws, 8 - 32 NC x 7/16 fillister head	Consult
	15665	Reducing glands for 1/2 NPT Cord-grips	Consult
	15887	6-position screw terminal for load cell connection	Consult
	19538	Cord-grip plugs	Consult
	94422	Capacity label	Consult
	53075	Cable shield ground clamps	Consult
	77180	8-position screw terminal for J10 (Rev. H CPU and higher)	Consult
	70599	6-position screw terminals for J2	Consult
	71126	4-position screw terminal for J9	Consult
	71125	3-position screw terminal for J11	Consult
	42149	Rubber feet for tilt stand	Consult
	103988	Nylon washers for tilt stand, 1/4 x 1 x 1/16	Consult
	103610	Wing knobs for tilt stand, internal thread	Consult
	67887	Installation manual	Consult
	67531	Tilt stand	Consult
1	66502	Switch panel membrane	Consult
2	67529	Enclosure universal	Consult
5	164371	LCD display transmissive (indoor use) CCFL B/L	Consult
	186273	LCD display transmissive (indoor use) with LED B/L	Consult
	186276	LCD display transfective (outdoor use) with LED B/L	Consult
	159946	CCFL backlight for display (type WRUS)	Consult
	187677	LED backlight for display (type WRUS, IQSS, ZARS)	Consult
6	67886	Standoffs, short	Consult
7	68661	Standoffs, long	Consult
8	117930	CPU board green solder mask	Consult
	186272	CPU board blue solder mask	Consult
9	14626	Nut, KEP, 4-40 NC hex	Consult
10	67613	Power supply, VAC, 25W	Consult
10	132791	Power supply, 12-24VDC, 25W	Consult
11	94392	Power supply bracket universal	Consult
12	16861	Label, warning high	Consult
13	58248	Lock nuts, 6 - 32 NC, nylon	Consult
14	14822	Machine screws, 4 - 40 NC x 1/4	Consult
15	67530	Interface board connector plate	Consult
16	67535	Interface board gasket	Consult
17	14862	Machine screws, 8 - 32 NC x 3/8	Consult
18	75062	#8 bonded sealing washer 7/16 OD	Consult
19	42640	Screw, mach 1/4-28 NF x 1/4 Phillips, drilled fillister head, 18-8	Consult
20	44676	Sealing washer for set-up switch access screw	Consult
21	15626	Cord-grips, PG9	Consult
22	15627	Lock nuts, PCN9	Consult
23	30375	Nylon seal rings for PG9 Cord-grips	Consult
25	15134	Lock washers, no. 8, type A	Consult
26	14626	Nut, KEP #8-32 NC hex	Consult
27	45043	Ground wire, 4" with no. 8 eye connector	Consult
28	68424	Enclosure backplate universal	Consult
	119891	Enclosure backplate for USB receptacles	Consult
31	85202	Power cord assembly, 115VAC and 230VAC North American units	Consult
	69998	Power cord assembly, 230VAC European units	Consult

(See Diagram 920i-D)

Indicators/Controllers

920i® Universal Indicator/Controller

Main Assembly

Part Number/Price

Ref#	Part#	Description	Price
32	67796	Wire harness, 920i 25W PS to CPU	Consult
	186464	Alternative power supply cables for display retrofit	Consult
33	68662	Cable, ribbon interface board to CPU	Consult
34	16892	Label, ground protective	Consult
35	15650	Cable tie mount, 3/4"	Consult
36	68216	Nameplate, Rice Lake	Consult
39	67532	Backplate gasket universal	Consult
41	68532	Single-channel A/D card	Consult
	68533	Dual-channel A/D card (shown in diagram 920i-D)	Consult
	87697	Analog input and thermocouple option	Consult
	67600	Memory, 1 MB NV RAM option	Consult
	67601	Digital I/O, 24-channel option	Consult
	67602	Analog output: selectable 0-10V, 0-20 mA option	Consult
	103138	Analog output, dual channel 0-10VDC, 0-20 mA option	Consult
	67604	Serial, dual channel option	Consult
	67603	Pulse input, single channel option	Consult
	68541	DeviceNet™ interface option	Consult
	68539	Allen-Bradley® Remote I/O interface option	Consult
	68540	Profibus® DP interface option	Consult
	103136	Control net interface option	Consult
	87803	EtherNet/IP (for A-B PLC) option	Consult
	71986	Ethernet TCP/IP 10/100 Base-T module (internal) option	Consult
45	67869	Board, interface 920i	Consult
46	55708	Screw, mach 4-40 NC x 3/8 Phillips pan head internal tooth lock washer SEMS	Consult
47	14845	Screw, Mach 6-32 NC x 3/8	Consult
50	15628	Cord-grips, 1/2 NPT	Consult
52	30376	Nylon seal rings for 1/2 NPT Cord-grips	Consult
53	15630	Lock nuts for 1/2 NPT Cord-grips	Consult
54	69290	Battery, 3V coin lithium	Consult
55	69898	Nylon spacers	Consult
60	88733	Vent, breather sealed Gortex membrane black plastic	Consult
61	88734	Nut, breather vent M12 x 1 thread	Consult
	68403	Wing knobs with threaded post, old style	Consult
	71027	Fuses (115VAC models), 2 A Time-Lag TR5	Consult
	71026	Fuses (230VAC models), 2 A Time-Lag TR5	Consult

The LED backlight display can be used with green CPU board Rev N or older by replacing the power supply cable. Universal 186464 (AC) 186464 (DC); Deep universal 186278 (AC) 187603 (DC); Panel 186278 (AC) 187603 (DC); Wall 186760 (AC) 188345 (DC); Two-slot expansion for wall 188716 (AC) 189724 (DC); Two-slot expansion panel for deep universal 188717 (AC) 189725 (DC); Six-slot expansion for wall 188774 (AC).
(See Diagram 920i-D)



INDICATORS

920i® Universal Indicator/Controller

Main Assembly

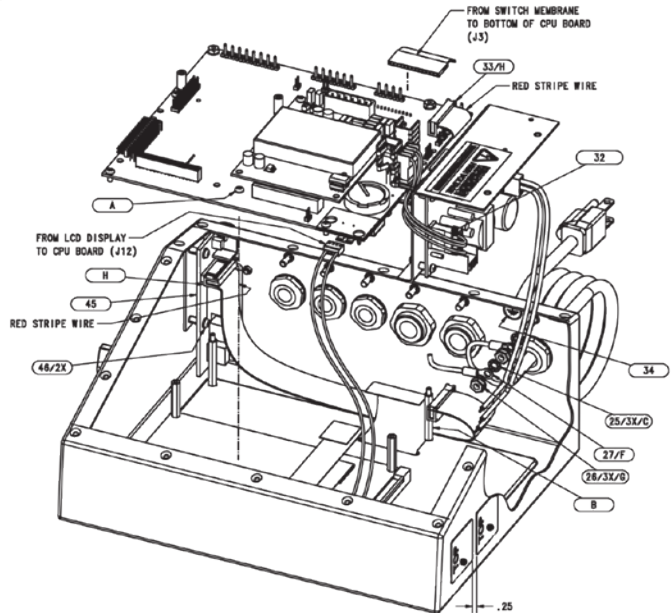
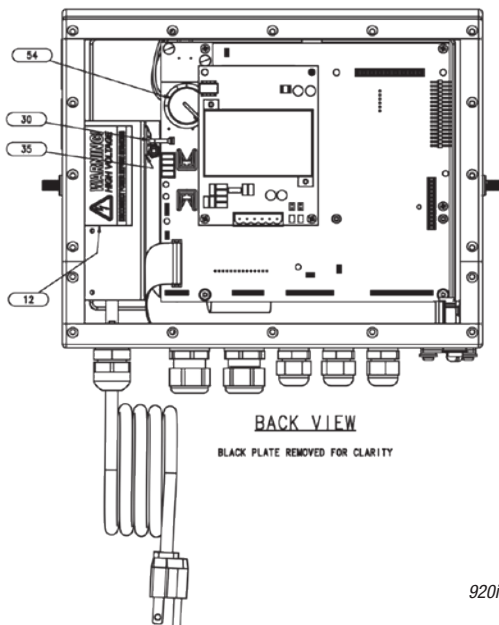
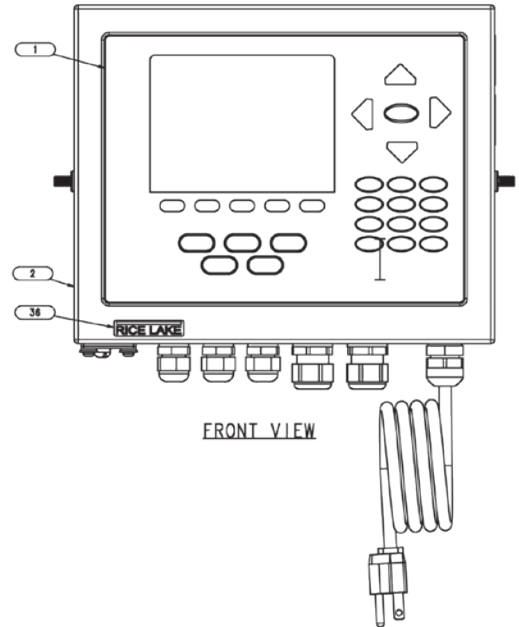
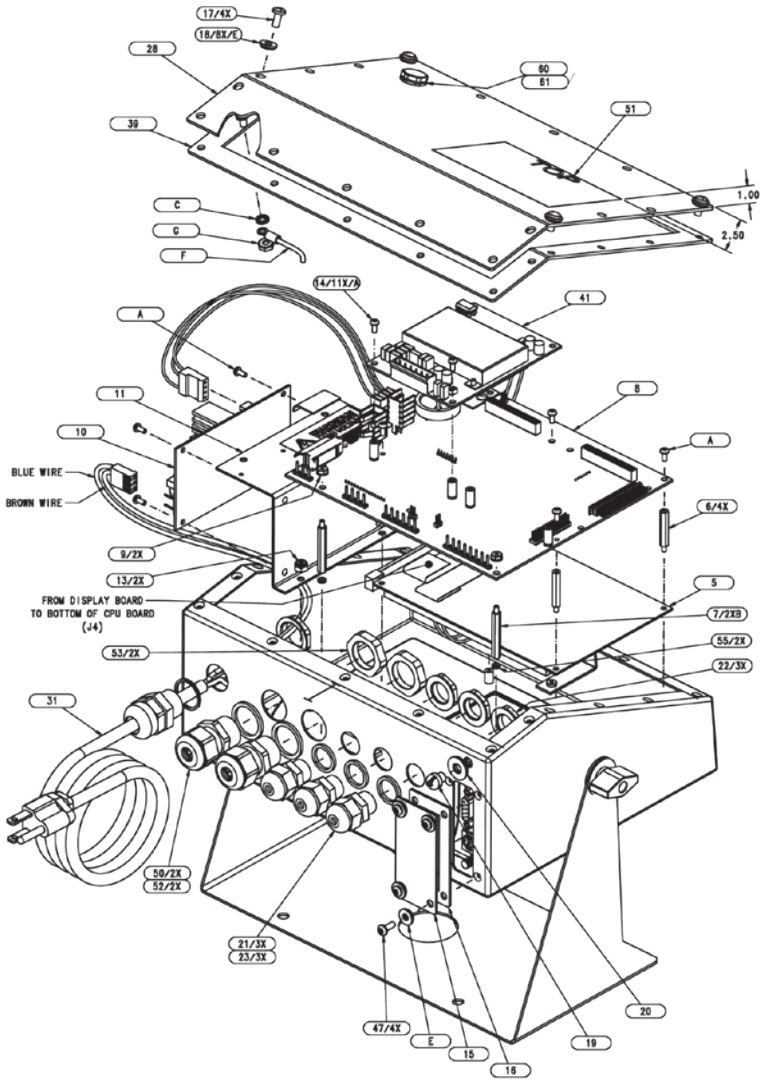

920i-D