

# MDB

Alloy Steel, Environmentally Sealed, IP67



**DISCONTINUED  
LIMITED STOCK  
AVAILABLE**

### APPROVALS



### Specifications

- Full Scale Output:**  
2 mV/V
- Output Resistance:**  
700 (± 5) ohm
- Input Resistance:**  
770 (± 10) ohm
- Material/Finish:**  
High alloy steel, nickel plated
- Temperature:**  
Operating range  
0° F to 150° F (-18° C to 65° C)
- Seal Type:**  
Environmentally sealed, IP67

### Dimensions

*Picture is a representation of actual product*

Rated Capacity	L	L1	L2	H	H1	H2	Ø	Ø1	W	W1	T1
t/mm											
10-30	240.0	125.0	80.0	230.0	11.0	20.0	88.0	30.0	135.0	100.0	2-M24
40-50	340.0	160.0	124.0	261.0	11.0	20.0	98.0	40.0	160.0	124.0	2-M24

### Order Information

Load Rating	Part #	Est. Weight	Price
10 t	169240	49 lb	\$550.00
20 t	169241	49 lb	\$550.00
25 t	169242	49 lb	\$550.00
30 t	169243	49 lb	\$550.00
40 t	169244	60 lb	\$1,195.00
50 t	169245	60 lb	\$1,195.00

*All capacities include cup and ball*

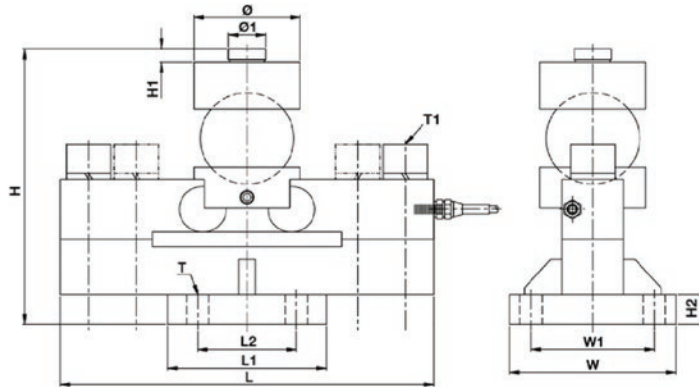

- Safe Overload:**  
50% full scale
- Rated Excitation:**  
5-10 VDC (15 VDC max)
- Nonlinearity:**  
0.030% full scale
- Hysteresis:**  
0.030% full scale
- Insulation Resistance:**  
5,000 megohms
- Cable Length:**  
13.5 m
- Cable Color Code:**  
Red +Excitation  
Black -Excitation  
Green +Signal  
White -Signal
- Warranty:**  
One-year limited warranty
- Approvals:**  
cFMus