

# SQB-HSS

Stainless Steel, Welded Seal, NTEP Certified 1:5,000 Class III Multiple Cell, IP67



Picture is a representation of actual product

### Approvals



### Order Information

Load Rating	Part #	Est. Weight	Price
1,000 lb	67118	3 lb	Consult
2,000 lb	67119	3 lb	Consult
2,500 lb	67120	3 lb	Consult
4,000 lb	67122	3 lb	Consult
5,000 lb SE	67123	3 lb	Consult
5,000 lb LE	67124	5 lb	Consult
10,000 lb	67125	5 lb	Consult

SE=small envelope; LE=large envelope

### Dimensions

Rated Capacity	L	L1	L2	L3	W	H	D	T
lb/in								
1,000 to 5,000 SE	5.12	1.00	3.00	0.50	1.25	1.25	0.53	1/2-20 UNF
5,000 LE to 10,000	6.75	1.50	3.75	0.75	1.50	1.50	0.78	3/4-16 UNF

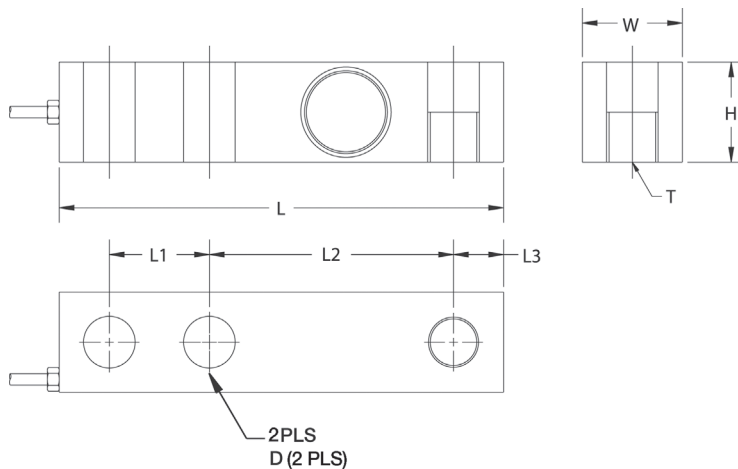

### Interchangeable Products

VPG® SENSORTRONICS®  
**65083**..... page 284

### Weigh Module Available

RICE LAKE WEIGHING SYSTEMS  
**RL1800 Series**..... page 52

### Specifications

- Full Scale Output:**  
3.0 mV/V
- Output Resistance:**  
350 (± 3) ohm
- Input Resistance:**  
385 (± 5) ohm
- Material/Finish:**  
Stainless steel
- Temperature:**  
Compensated:  
14 °F to 104 °F (-10 °C to 40 °C)  
Operating:  
0 °F to 150 °F (-18 °C to 65 °C)
- Seal Type:**  
Welded-seal, IP67
- Safe Overload:**  
150% full scale
- Safe Sideload:**  
100% full scale
- Rated Excitation:**  
5 to 15 VDC
- Combined Error:**  
0.02 full scale
- Insulation Resistance:**  
5,000 megohm
- Cable Length:**  
20 ft
- Cable Diameter:**  
0.200 in  
Polyurethane jacket
- Cable Color Code:**  
Red +Excitation  
Black -Excitation  
Green +Signal  
White -Signal
- Warranty:**  
One-year limited
- Approvals:**  
cFMus  
NTEP