

Load Pin - 2.5 Inch, 20K

Alloy Steel, Environmentally Sealed

Specifications

Full Scale Output:

1.3 mV/V

Output Resistance:

350 (nominal)

Input Resistance:

350 (nominal)

Material/Finish:

Alloy steel

Temperature:

14° F to 104° F (-10° C to 40° C)

Rated Excitation:

15 VDC (5-10 V recommended)

Insulation Resistance:

500 megohms at 50 VDC

Seal Type:

Environmentally sealed

Connector Type:

Turck, M12 4-pin male

Connection Pin Out:

Pin 1 - Excitation +
 Pin 2 - Signal +
 Pin 3 - Excitation -
 Pin 4 - Signal -

Warranty:

One-year limited warranty



Order Information

Picture is a representation of actual product

Load Rating	Part #	Est. Weight	Price
20,000 lbs	131204	12 lbs	Consult

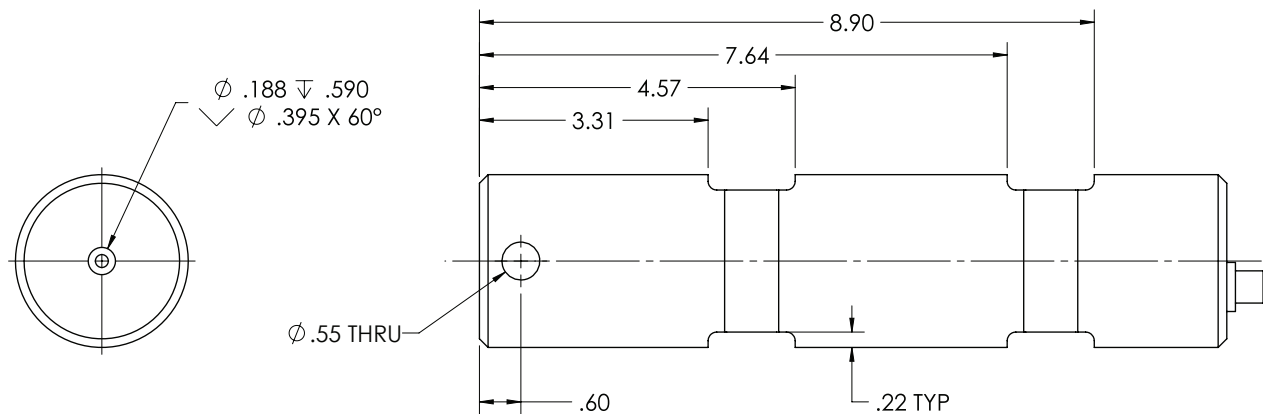
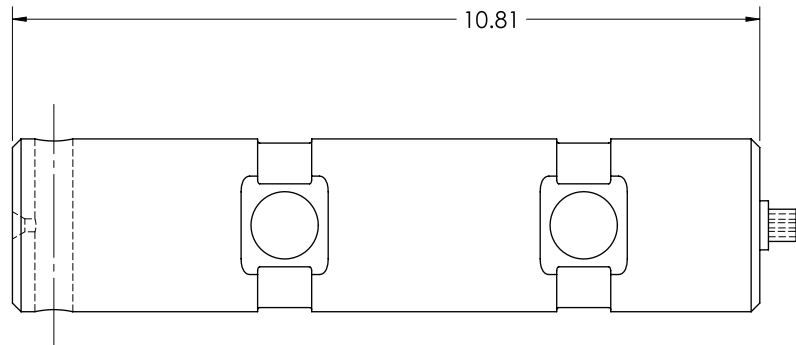
ONBOARD WEIGHING
LOAD CELLS