

LOAD CELL

# Load Pin - 2 Inch, 20K

Alloy Steel, Environmentally Sealed

ONBOARD WEIGHING



## Specifications

**Full Scale Output:**

1.3 mV/V

**Material/Finish:**

Alloy steel

**Temperature:**

14° F to 104° F (-10° C to 40° C)

**Rated Excitation:**

15VDC (5-10V recommended)

**Insulation Resistance:**

500 megohms at 50VDC

**Seal Type:**

Environmentally sealed

**Connector Type:**

Turck, M12 4-pin male

**Connection Pin Out:**

Pin 1 - Excitation +

Pin 2 - Signal +

Pin 3 - Excitation -

Pin 4 - Signal -

**Warranty:**

One-year limited warranty

## Order Information

*Picture is a representation of actual product*

Load Rating	Part#	Est. Weight	Price
20,000 lbs	181895	10 lbs	Consult

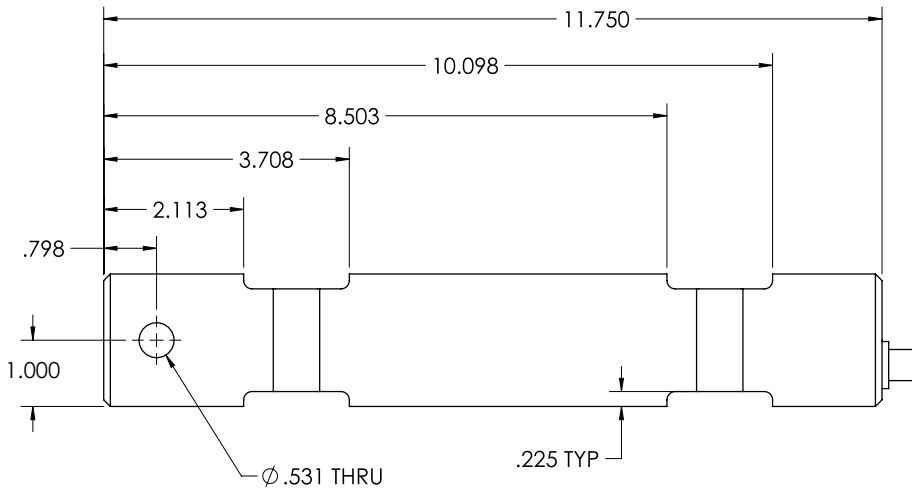
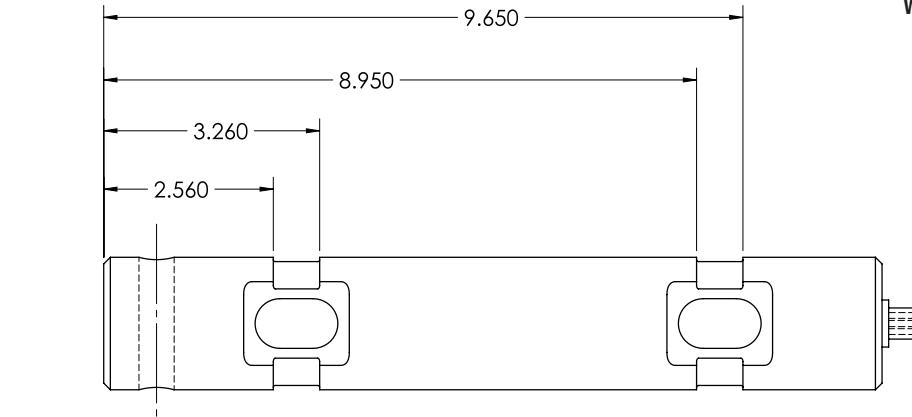

www.ricelake.com | Phone: 800-472-6703

RICE LAKE