



Picture is a representation of actual product

Approvals



Order Information

| Load Rating | Part # | Est. Weight | Price |
|----------------------------------------|---------------|-------------|---------|
| NTEP Certified, 30 ft Cable | | | |
| 25,000 lb | 21649 | 7 lb | Consult |
| 50,000 lb | 21650 | 7 lb | Consult |
| 100,000 lb | 21651 | 15 lb | Consult |
| 200,000 lb | 21652 | 36 lb | Consult |
| NTEP Certified, 60 ft Cable | | | |
| 200,000 lb | 188769 | 40 lb | Consult |
| Non-NTEP Certified, 30 ft Cable | | | |
| 10,000 lb | 17595 | 6 lb | Consult |
| 300,000 lb | 17597 | 40 lb | Consult |
| 500,000 lb | 17598 | 40 lb | Consult |
| OIML, 60 ft Cable | | | |
| 60T | 194528 | 15 lb | Consult |

Dimensions

| Rated Capacity | A | B | C | D | E | F | G | H | DEPTH of H |
|--------------------|------|------|------|-------|------|------|------|------------|------------|
| lb/in | | | | | | | | | |
| 10,000 to 50,000 | 2.88 | 3.25 | 1.28 | 6.00 | 2.51 | 0.40 | 1.25 | 1/2-20 UNF | 0.38 |
| 100,000 | 4.12 | 5.00 | 2.15 | 6.00 | 3.39 | 0.51 | 2.31 | 3/4-16 UNF | 0.56 |
| 200,000 to 300,000 | 6.00 | 7.25 | 3.63 | 17.00 | 4.26 | 1.04 | 3.13 | 3/4-16 UNF | 0.75 |
| 500,000 | 6.50 | 9.00 | 4.34 | 17.00 | 4.59 | 0.56 | 3.69 | 3/4-16 UNF | 0.75 |

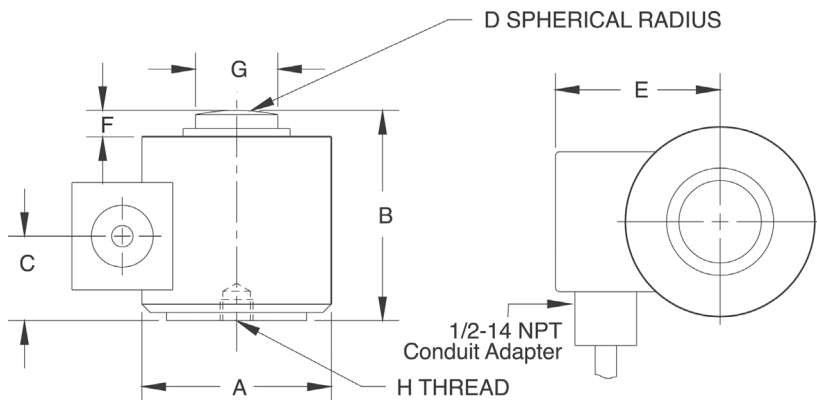

Interchangeable Products

- RICE LAKE WEIGHING SYSTEMS
- RLCSP1*** page 145
- VPG® REVERE
- 692B*** Discontinued
- ARTECH®
- 90310***
- HOWE RICHARDSON®
- 244699-000X***
- STREETER AMET®
- 3760XXX**

* Load cell diameter may not be identical

Weigh Module Available

- RICE LAKE WEIGHING SYSTEMS
- MagnaMount®** page 80

Specifications

- Full Scale Output:**
2 mV/V
- Output Resistance:**
480 (± 4.8) ohm
- Input Resistance:**
450 (± 4.5) ohm
- Material/Finish:**
Stainless steel
- Temperature:**
Compensated:
14 °F to 104 °F (-10 °C to 40 °C)
Operating:
0 °F to 150 °F (-18 °C to 65 °C)
- Seal Type:**
Welded-seal, IP68
- Safe Overload:**
150% full scale
- Rated Excitation:**
5 to 10 VDC (15 V maximum)
- Combined Error:**
0.02% full scale (0.05% Non-NTEP Certified)
- Non-repeatability:**
0.01% full scale
- Insulation Resistance:**
5,000 megohm
- Deflection at Capacity:**
10,000 to 50,000 lb: 0.003 in
100,000 to 300,000 lb: 0.006 in
500,000 lb: 0.009 in
- Cable Length:**
30 ft
60 ft
- Cable Diameter:**
0.295 in
Polyurethane jacket
- Cable Color Code:**
Green +Excitation
Black -Excitation
White +Signal
Red -Signal
- Warranty:**
One-year limited
- Approvals:**
cFMus
NTEP
OIML

VPG® REVERE