

RL75016SS-W

Stainless Steel, Welded Seal, IP67



Picture is a representation of actual product.

Order Information

Load Rating	Part #	Est. Weight	Price
5,000 lb	168115	4 lb	Consult
10,000 lb	168116	7 lb	Consult
15,000 lb	168117	7 lb	Consult
20,000 lb	168118	7 lb	Consult
25,000 lb	168119	7 lb	Consult

Dimensions

Rated Capacity	A1	A2	C	D	E	F	G
lb/in							
5,000	0.50	1.25	1.25	1.25	7.50	6.25	0.69
10,000 to 25,000	0.81	1.99	1.44	1.94	8.75	7.50	0.96

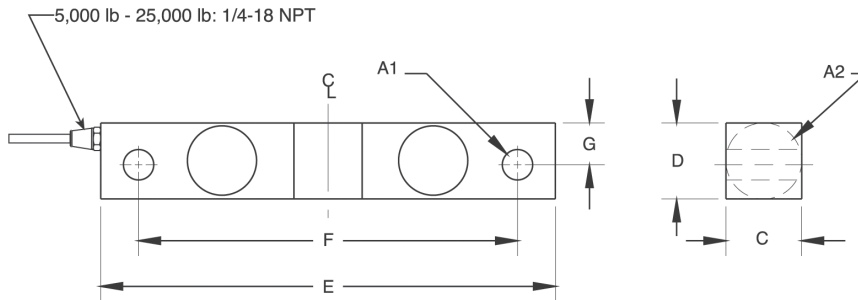

RICE LAKE
LOAD CELLS

Interchangeable Products

- RICE LAKE WEIGHING SYSTEMS
RL77032SS HE..... page 132
- RICE LAKE WEIGHING SYSTEMS
RL75016SS..... page 135
- RICE LAKE WEIGHING SYSTEMS
RL75016WHE..... page 137

Specifications

- Full Scale Output:**
3.0 mV/V
- Output Resistance:**
700 (± 5) ohm
- Input Resistance:**
770 (± 10) ohm
- Material/Finish:**
Stainless steel
- Temperature:**
Operating:
0 °F to 150 °F (-18 °C to 65 °C)
- Seal Type:**
Welded-seal, IP67
- Safe Overload:**
100% full scale
- Rated Excitation:**
5 to 10 VDC (15 V max)
- Hysteresis:**
0.02% full scale
- Linearity:**
0.03% full scale
- Cable Length:**
25 ft
- Cable Color Code:**
Red +Excitation
Black -Excitation
Green +Signal
White -Signal
- Warranty:**
Two-year limited