



Picture is a representation of actual product.

**Approvals**



**Order Information**

Load Rating	Part #	Est. Weight	Price
<b>NTEP Certified 35 ft Cable</b>			
20,000 lb	197797	8 lb	Consult
25,000 lb	197798	8 lb	Consult
40,000 lb	198430	13 lb	Consult
50,000 lb	197799	19 lb	Consult
60,000 lb	197800	19 lb	Consult
75,000 lb	197801	19 lb	Consult
100,000 lb	197803	40 lb	Consult
125,000 lb	197804	40 lb	Consult
<b>Non-NTEP Certified 35 ft Cable</b>			
10,000 lb	197796	8 lb	Consult
<b>NTEP Certified 60 ft Cable</b>			
75,000 lb	197802	20 lb	Consult

**Dimensions**

Rated Capacity	A	B	C	D	E	F	ØG	H	I	J	K
lb/in											
10,000 to 25,000	7.75	1.38	1.94	1.69	1.70	6.50	0.68	1/4-18 NPT	R19.1	R22.9	1.63
40,000	10.25	1.93	2.44	1.94	2.10	8.50	0.81	1/4-18 NPT	R25.4	R28.5	2.00
50,000 to 75,000	10.25	1.93	2.94	2.44	2.65	8.50	1.06	1/2-14 NPT	R25.4	R34.8	2.54
100,000 to 125,000	15.25	3.13	3.86	2.90	3.43	12.75	1.62	1/2-14 NPT	R38.1	R45.7	3.30

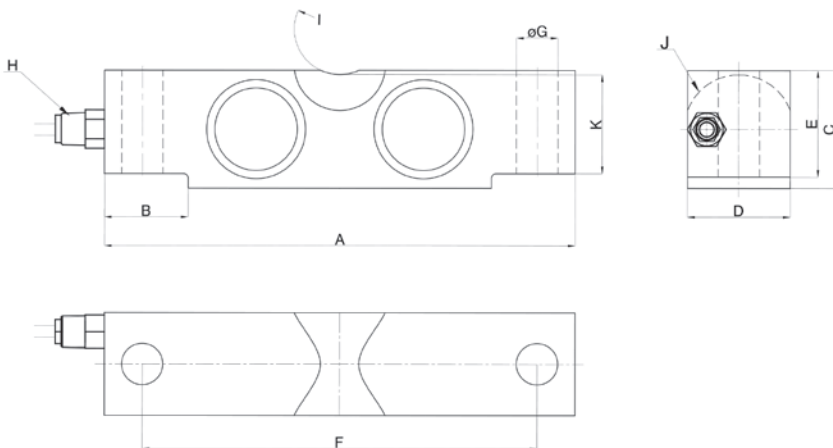

**Interchangeable Products**

VPG® SENSORTRONICS®  
**65058S**.....page 310

**Weigh Module Available**

RICE LAKE WEIGHING SYSTEMS  
**RL2100HE**..... page 36  
 RICE LAKE WEIGHING SYSTEMS  
**MVS**..... page 86

**Specifications**

- Full Scale Output:**  
3.0 mV/V
- Output Resistance:**  
700 (± 7) ohm
- Input Resistance:**  
700 (± 14) ohm
- Material/Finish:**  
Stainless steel
- Temperature:**  
Compensated range  
14 °F to 104 °F (-10 °C to 40 °C)  
Operating range  
0 °F to 150 °F (-18 °C to 65 °C)
- Seal Type:**  
Hermetically sealed, IP68/IP69K
- Safe Overload:**  
150% full scale
- Safe Sideload:**  
100% full scale
- Rated Excitation:**  
5 to 10 VDC (15 V maximum)
- Combined Error:**  
0.02% full scale
- Insulation Resistance:**  
5,000 megohm
- Cable Length:**  
35 ft  
60 ft
- Cable Diameter:**  
10,000 to 25,000 lb: 0.200 in  
40,000 to 125,000 lb: 0.305 in  
Polyurethane jacket
- Cable Coloring Code:**  
Red +Excitation  
Black -Excitation  
Green +Signal  
White -Signal
- Warranty:**  
Two-year limited
- Approvals:**  
cFMus  
NTEP 20-081

**RICE LAKE  
LOAD CELLS**