

RoughDeck® AX

Tandem Axle Scale



Standard Features

- System includes two platforms with anchor brackets and four on/off ramps with anchor tabs (anchor bolts not included)

Scale

- (L x W x H): 84 x 32 x 6 in
- Axle capacity, tandem platforms: 60,000 lb (two scales 30,000 lb each)
- Includes (2) 3/4-10 NC eye bolts for lifting scale during installation
- Contains four environmentally sealed, IP67 20,000 lb single-ended shear beam load cells per platform
- Treaded top plate with side access junction box
- JB4SS TuffSeal® signal trim junction box
- Top access foot adjustment holes
- Carbon steel captured ball feet
- 20 ft SURVIVOR® EL147HE cable
- Non-Legal for Trade

Ramps

- (L x W x H) 60 x 32 x 6 in
- Treaded top plate

Specifications

End Loading Capacity:
133% full scale at 30,000 lb

Warranty:

Load cells: Two-years
All other components: One-year limited

Part Number/Price

Part #	Description	Dimensions (L x W x H)	Est. Weight	Price
107637	60,000 lb (30,000 lb each)	84 x 32 x 6 in	3,600 lb	Consult

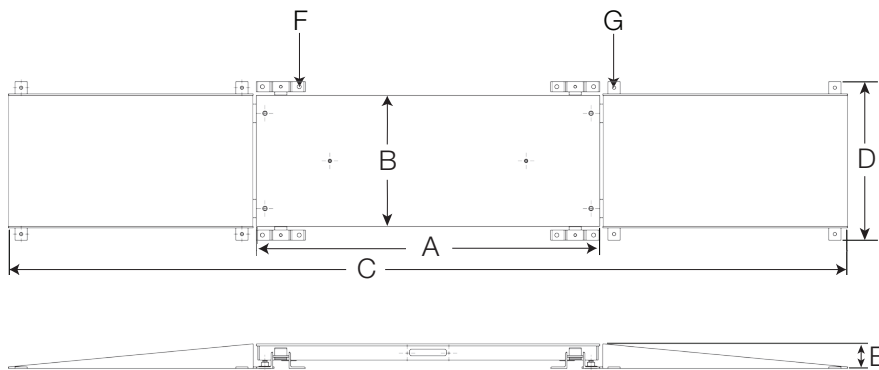

Dimensions

RoughDeck AX	
A	84.00 in
B	32.00 in
C	205.50 in
D	38.75 in
E	6.00 in
F	1.00 in
G	0.75 in

Note: 1 in = 25.4 mm

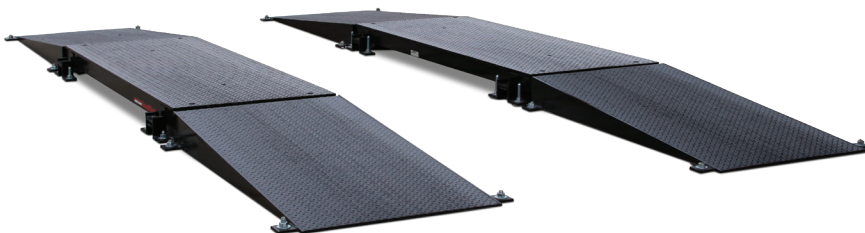

AXLE SCALES