



Picture is a representation of actual product

**Approvals**



**Order Information**

Load Rating	Part #	Est. Weight	Price
<b>NTEP Certified</b>			
500 lb	36272	3 lb	Consult
750 lb	36273	3 lb	Consult
1,000 lb	36274	3 lb	Consult
1,500 lb	36275	3 lb	Consult
2,000 lb	36276	3 lb	Consult
2,500 lb	36277	3 lb	Consult
3,000 lb	36278	3 lb	Consult
5,000 lb	36279	4 lb	Consult
<b>Non-NTEP Certified</b>			
10,000 lb	36280	4 lb	Consult

**Dimensions**

Rated Capacity	A	B	D	E
lb/in				
500 to 3,000	1/2-20 UNF	1.00	2.00	3.00
5,000 to 10,000	3/4-16 UNF	1.00	3.50	4.75

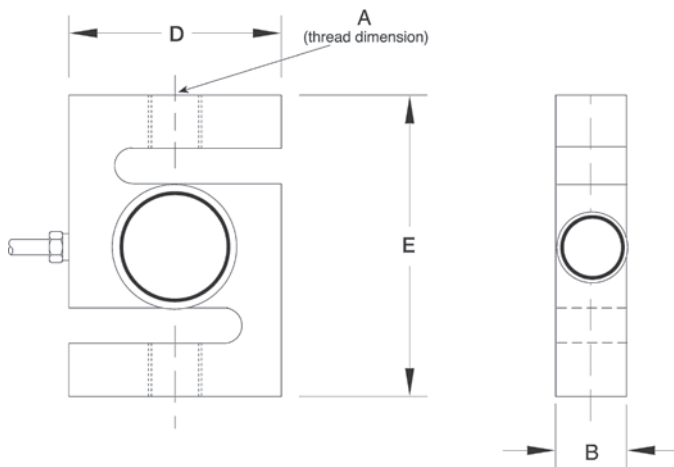

**Interchangeable Products**

RICE LAKE WEIGHING SYSTEMS  
RL20001HE.....page 110

**Weigh Module Available**

RICE LAKE WEIGHING SYSTEMS  
ITCM Isolated Tension  
Cell Mount..... page 40

**Specifications**

**Full Scale Output:**

2.0 mV/V

**Output Resistance:**

349 to 355 ohm

**Input Resistance:**

349 to 350 ohm

**Material/Finish:**

Stainless steel

**Temperature:**

Compensated range

14 °F to 104 °F (-10 °C to 40 °C)

Operating range

0 °F to 150 °F (-18 °C to 65 °C)

**Seal Type:**

Welded-seal, IP68

**Safe Overload:**

150% full scale

**Rated Excitation:**

5 to 10 V DC (15 V maximum)

**Combined Error:**

0.03% full scale

**Insulation Resistance:**

5,000 megohm

**Cable Length:**

20 ft

**Cable Diameter:**

0.200 in

polyurethane jacket

**Cable Color Code:**

Red +Excitation

Black -Excitation

Green +Signal

White -Signal

**Warranty:**

One-year limited

**Approvals:**

cFMus

NTEP