

Picture is a representation of actual product

### Approvals



### Order Information

Load Rating	Part #	Est. Weight	Price
<b>Threaded Hole</b>			
1,000 lb	<b>28925</b>	3 lb	Consult
2,000 lb	<b>28926</b>	3 lb	Consult
2,500 lb	<b>28927</b>	3 lb	Consult
2,500 lb*	<b>170030</b>	3 lb	Consult
4,000 lb	<b>28929</b>	3 lb	Consult
5,000 lb	<b>28930</b>	5 lb	Consult
10,000 lb	<b>28931</b>	5 lb	Consult

\*65023S 2,500lb- 5513, low-profile 0.75 inches tall

### Dimensions

Rated Capacity	A1	A2	A3	B	C	D	E	F	G
1,000 to 4,000	1/2-20 UNF	0.62	0.53	1.00	1.25	5.12	1.00	3.00	0.50
5,000 to 10,000	3/4-16 UNF	0.75	0.78	1.50	1.50	6.75	1.50	3.75	0.75

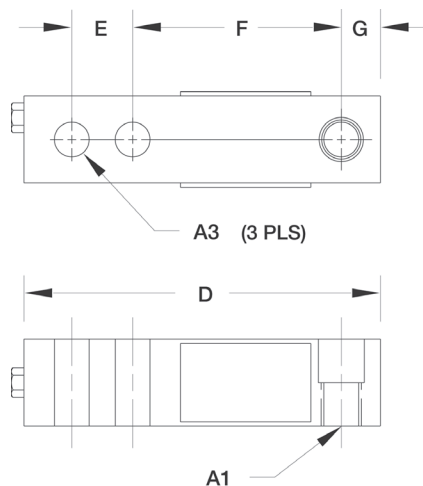

### Interchangeable Products

VPG® SENSORTRONICS®  
**65023SS** ..... page 282

### Weigh Module Available

RICE LAKE WEIGHING SYSTEMS  
**RL50210TA**..... page 41  
RICE LAKE WEIGHING SYSTEMS  
**RL1800 Series**..... page 52

### Specifications

**Full Scale Output:**

3.0 mV/V

**Output Resistance:**

349 to 355 ohm

**Input Resistance:**

343 to 357 ohm

**Material/Finish:**

Stainless steel

**Temperature:**

Compensated:

14 °F to 104 °F (-10 °C to 40 °C)

Operating:

0 °F to 150 °F (-18 °C to 65 °C)

**Seal Type:**

Environmentally sealed, IP67

**Safe Overload:**

150% full scale

**Rated Excitation:**

5 to 10 VDC (15 V maximum)

**Combined Error:**

0.02% full scale

**Insulation Resistance:**

5,000 megohm

**Deflection at Capacity:**

500 to 1,000 lb: 0.013 in

1,500 to 4,000 lb: 0.017 to 0.025 in

5,000 to 10,000 lb: 0.025 to 0.035 in

15,000 to 20,000 lb: 0.048 to 0.063 in

**Cable Length:**

20 ft

**Cable Color Code:**

Red +Excitation

Black -Excitation

Green +Signal

White -Signal

**Warranty:**

One-year limited

**Approvals:**

cFMus

NTEP