

Picture is a representation of actual product

**Approvals**



**Order Information**

| Load Rating                          | Part # | Est. Weight | Price   |
|--------------------------------------|--------|-------------|---------|
| <b>1010 NTEP Certified, Potted</b>   |        |             |         |
| 10 kg                                | 33727  | 2 lb        | Consult |
| 15 kg                                | 33728  | 2 lb        | Consult |
| 20 kg                                | 33729  | 2 lb        | Consult |
| 30 kg                                | 33730  | 2 lb        | Consult |
| 50 kg                                | 33731  | 2 lb        | Consult |
| <b>1010 Non-NTEP, Potted</b>         |        |             |         |
| 5 kg                                 | 17462  | 2 lb        | Consult |
| 7 kg                                 | 17463  | 2 lb        | Consult |
| 10 kg                                | 17464  | 2 lb        | Consult |
| 20 kg                                | 17482  | 2 lb        | Consult |
| 30 kg                                | 17475  | 2 lb        | Consult |
| 50 kg                                | 17476  | 2 lb        | Consult |
| 90 kg                                | 17471  | 2 lb        | Consult |
| <b>1010 NTEP Certified, Unpotted</b> |        |             |         |
| 5 kg                                 | 33732  | 2 lb        | Consult |
| 7 kg                                 | 33733  | 2 lb        | Consult |
| <b>1010 Non-NTEP, Unpotted</b>       |        |             |         |
| 3 kg                                 | 17481  | 1.2 lb      | Consult |
| <b>1015 NTEP Certified, Potted</b>   |        |             |         |
| 5 kg                                 | 188805 | 2 lb        | Consult |
| 7 kg                                 | 188806 | 2 lb        | Consult |
| 10 kg                                | 188807 | 2 lb        | Consult |
| 15 kg                                | 188808 | 2 lb        | Consult |
| 20 kg                                | 188809 | 2 lb        | Consult |
| 30 kg                                | 188810 | 2 lb        | Consult |
| 50 kg                                | 188811 | 2 lb        | Consult |
| <b>1015 Non-NTEP, Potted</b>         |        |             |         |
| 3 kg                                 | 188804 | 1.2 lb      | Consult |
| 90 kg                                | 188812 | 2 lb        | Consult |

Note: Model 1015 has M6 metric threads

**Dimensions**

| Rated Capacity | A     | B    | C   | D     | E    | F    | G    | H  | K   | L    | M    | N    |
|----------------|-------|------|-----|-------|------|------|------|--|-----|------|------|------|
| kg/mm          |       |      |     |       |      |      |      |  |     |      |      |      |
| 3 to 90        | 118.0 | 34.0 | 3.0 | 110.5 | 66.0 | 80.0 | 25.0 | (1010)<br>1/4-20 UNC × 13 DP<br>(1015) M6 Metric | 7.5 | 19.1 | 25.4 | 33.5 |

**Interchangeable Products**

RICE LAKE WEIGHING SYSTEMS  
RL1010.....page 159

**Specifications**

- Full Scale Output:** 2.0 mV/V
- Output Resistance:** 350 (± 3) ohm
- Input Resistance:** Model 1010: 415 (± 15) ohm  
Model 1015: 350 (± 3) ohm
- Material/Finish:** Aluminum
- Temperature:** Compensated: 14 °F to 104 °F (-10 °C to 40 °C)  
Operating: 0 °F to 150 °F (-18 °C to 65 °C)
- Seal Type:** Environmentally sealed  
Potted: IP67  
Unpotted: IP65
- Safe Overload:** 150% at center of loading point, full scale
- Rated Excitation:** 5 to 10 VDC (15 V maximum)
- Combined Error:** 0.02% full scale
- Deflection at Capacity:** 0.015 in
- Cable Length:** 10 ft
- Cable Diameter:** 0.200 in  
PVC jacket
- Cable Color Code:** Green +Excitation  
Black -Excitation  
Red +Signal  
White -Signal  
Blue +Sense  
Brown -Sense
- Max Platform Size:** 15.75 × 15.75 in
- Warranty:** One-year limited
- Approvals:** cFMus  
NTEP

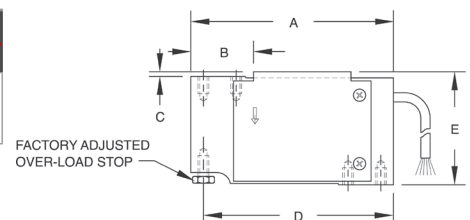
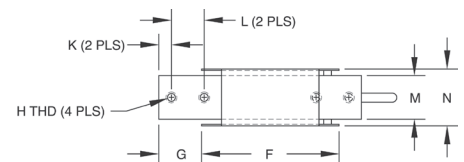

**VPG®**  
**TEDEA-HUNTLEIGH®**