



Picture is a representation of actual product

Approvals



Available upon request

Available upon request

Order Information

Load Rating	Part #	Est. Weight	Price
5 kg	30165	2 lb	Consult
10 kg	30166	2 lb	Consult
20 kg	30167	2 lb	Consult
50 kg	30168	2 lb	Consult
100 kg	30169	2 lb	Consult
200 kg	30170	2 lb	Consult
500 kg	36463	2 lb	Consult

Dimensions

Rated Capacity	A	B	C	D	E	F	G	H	J	K	M	N
kg/mm												
5 to 500	120.0	40.0	23.0	32.0	20.5	45.5	10.0	82.0	18.0	20.0	20.0	8.2

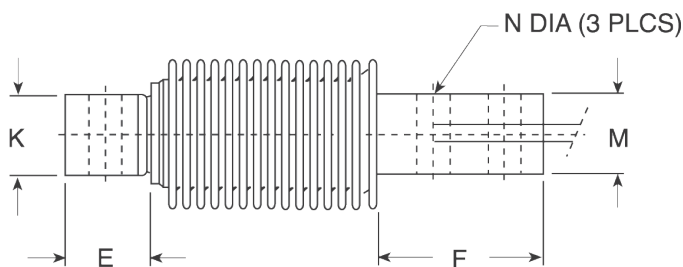
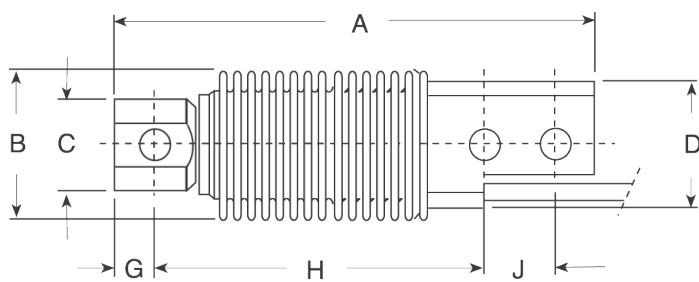

Interchangeable Products

- RICE LAKE WEIGHING SYSTEMS
- RL9018SS .....page 111
- VPG® REVERE
- SHB..... page 253
- HBK®
- Z6 .....page 226

Weigh Module Available

- RICE LAKE WEIGHING SYSTEMS
- RL1700 HE .....page 33

Specifications

- Full Scale Output:** 2.0 mV/V
- Output Resistance:** 355 (± 5) ohm
- Input Resistance:** 380 (± 10) ohm
- Material/Finish:** Stainless steel
- Temperature:** Compensated: 14 °F to 104 °F (-10 °C to 40 °C)  
Operating: 0 °F to 150 °F (-18 °C to 65 °C)
- Seal Type:** Welded-seal, IP68
- Safe Overload:** 150% full scale
- Rated Excitation:** 5 to 10 VDC (15 V maximum)
- Combined Error:** 0.02% full scale
- Insulation Resistance:** 2,000 megohm
- Deflection at Capacity:** 0.015 in
- Cable Length:** 10 ft
- Cable Diameter:** 0.220 in  
Polyurethane jacket
- Cable Color Code:** Blue +Excitation  
Black -Excitation  
White +Signal  
Red -Signal  
Green +Sense  
Grey -Sense
- Warranty:** One-year limited
- Approvals:** cFMus  
NTEP  
Ex (Available upon request)  
OIML (Available upon request)

VPG®  
TEDEA-HUNTLEIGH®