

# Printer Unit

## Part Number/Price

REF #	PART #	DESCRIPTION	QTY	SYNONYM	PRICE
1	187431	Shaft, step type	2	000-150-3084-03	Consult
2	157891	Roller, blue, label, hold assy	11	000-079-8591-03	Consult
3	Consult	Frame, hold, lon	1	100-000-1117-01	Consult
4	157916	Collar	6	000-091-8682-18	Consult
5	157917	Collar	38	000-077-4891-20	Consult
6	Consult	Frame, hold	1	000-078-0812-19	Consult
7	187432	Shaft, stock	1	000-136-3566-07	Consult
8	Consult	Bracket, sensor, R	1	000-078-0813-03	Consult
9	Consult	Bracket, sensor, L	1	000-078-0816-04	Consult
10	187433	Shaft, roller, assist	2	000-044-3821-17	Consult
11	110525	Roller, assist	1	000-060-8956-04	Consult
12	195784	Plate A, holder	1	000-136-3565-03	Consult
13	195782	Bracket, assist printer	2	000-078-0818-01	Consult
14	187438	Collar, spacer	4	000-059-4384-06	Consult
15	187439	Spring, coil, compressive	4	000-086-7397-10	Consult
16	Consult	Bracket, assist, upper	1	000-078-0820-19	Consult
17	187440	Spring, coil	1	000-078-0821-12	Consult
18	187441	L plate A	1	000-078-0822-07	Consult
19	187444	L plate A, press	1	000-078-0823-01	Consult
20	187445	Collar, spacer	1	000-027-6196-08	Consult
21	187446	Spring, coil, compressive	4	000-072-5278-14	Consult
22	187447	Roller, assist	1	000-069-4967-06	Consult
23	187448	Spring, plate	1	000-075-5774-08	Consult
24	187449	Guide, printer, cassette	1	000-075-5709-14	Consult
25	187366	Roller, pole	1	000-011-0853-07	Consult
26	187450	Collar, step	1	000-076-7629-05	Consult
27	187451	Shaft, guide, label	1	000-136-3568-04	Consult
28	187452	Guide, label	1	000-078-0987-17	Consult
29	187453	Guide, label	2	000-068-5048-46	Consult
31	178189	Shaft, label	2	000-136-3569-08	Consult
32	187454	Roller, guide	1	000-078-0991-03	Consult
33	172640	Motor assy, stepping, M10	1	000-111-5669-19	Consult
34	Consult	Bracket, motor	1	000-135-2562-11	Consult
35	187455	Gear, flat	1	000-135-7394-01	Consult
36	172641	Rail, slide	2	000-086-7470-19	Consult
37	172642	Catch, magnet	1	000-079-1224-01	Consult
38	187456	Collar, label	4	000-079-8952-04	Consult
39	200872	Bracket, plate, R	1	000-112-9515-11	Consult
40	187457	Timing pulley, S3M, C	2	000-073-7220-04	Consult
41	125887	Timing belt, CP-S3M	1	000-139-2517-02	Consult
42	171873	Platen roller, print	2	000-086-7371-13	Consult
43	Consult	Cover, belt	1	000-078-0830-43	Consult
44	187458	Shaft, peel	1	000-090-5345-05	Consult
45	187459	Shaft, idler	1	000-078-0831-10	Consult
46	206148	Bracket plate L-Assy	1	000-112-9538-07	Consult
47	187460	Shaft, stock	1	000-070-9862-47	Consult
48	187461	Timing pulley, S3M, AF	1	000-135-7395-13	Consult
49	93355	Bush	4	000-064-0201-24	Consult
50	187462	Bush	1	000-075-1324-01	Consult
51	187463	Bush	1	000-075-1325-04	Consult
52	172643	Bearing, radial, idler shaft	2	000-065-6920-00	Consult
53	Consult	Frame, printer	1	000-135-2561-62	Consult
54	171874	Winding assy, includes drive belt	1	000-143-5342-04	Consult
55	Consult	Cover, front	1	000-136-3984-02	Consult
56	172652	Spring, coil, compressive	1	000-079-1005-20	Consult

# Printer Unit

## Part Number/Price

REF #	PART #	DESCRIPTION	QTY	SYNONYM	PRICE
57	Consult	Hinge	1	000-013-9941-09	Consult
—	Consult	Screw, counter sink, M3x8	6		Consult
58	172662	Bracket assy, printer	1	000-138-5901-03	Consult
59	Consult	Bracket, printer, thermal	1	000-112-9535-06	Consult
60	187464	L plate A, spring support	1	000-078-0994-04	Consult
61	187465	Stay, head, thermal	1	000-078-0993-29	Consult
62	187466	Plate B, press head	1	000-078-0992-16	Consult
63	187467	Bracket, switch head	1	000-136-3564-00	Consult
64	205052	Guide, printer lower	1	000-078-0986-04	Consult
65	187468	Crank plate A, spring	1	000-091-2164-04	Consult
66	Consult	Bracket, printer	1	000-136-3563-06	Consult
67	Consult	Frame, printer, R	1	000-137-0968-16	Consult
68	Consult	Frame, printer, L	1	000-135-2560-71	Consult
69	Consult	Decal set, printer	1	100-001-4718-01	Consult
73	195827	Bracket, printer sensor	1	000-136-3986-26	Consult
74	187469	Shaft	1	000-137-0514-00	Consult
75	167125	Spring, plate	1	000-079-1227-01	Consult
76	195828	Bracket, sensor	1	000-135-4822-43	Consult
77	167127	Holder, sensor	1	000-076-1988-01	Consult
78	167128	Cover, sensor	2	000-078-0984-16	Consult
79	Consult	Cover, head	1	000-139-2504-04	Consult
80	193560	Lug	2	000-073-5832-06	Consult
81	159595	Catch, magnet	1	000-072-8605-01	Consult
82	Consult	Gasket	1	000-065-1825-01	Consult
84	172667	Spring, coil, compressive	3	000-072-8616-01	Consult
85	187470	Screw, cross pan head, M1.7x6 mm SST	2	000-090-5431-02	Consult
86	187471	Plain washer, M1.7 SST	2	000-090-5432-06	Consult
87	187472	Spring washer, M1.7 SST	2	000-090-5433-00	Consult
88	187473	Collar, B	2	000-079-8972-09	Consult
89	187474	Block A, assist	2	000-091-8679-07	Consult
90	187475	Collar A	2	000-095-9235-00	Consult
91	187476	Collar spacer	4	000-113-7378-08	Consult
92	Consult	Bracket, pulley, tension	1	000-137-0519-17	Consult
93	Consult	Plate A, label guide	1	000-148-4354-01	Consult
94	172635	Bearing radial, label shaft	2	000-000-3727-05	Consult
95	187477	Bush	1	000-075-1321-00	Consult
96	Consult	Guide assy, label	1	000-148-4353-10	Consult
101	187478	Collar	2	000-149-6798-06	Consult
102	186558	Shaft, step, short	2	000-149-6797-02	Consult
103	178225	C ring, for shaft, 3 mm ID	2	000-014-8693-09	Consult
104	178190	Roller, label	2	100-012-1219-00	Consult
501	171875	Print head, thermal, E10	1	100-010-2669-00	Consult
502	105979	Magnet, green, head up proximity switch, B14	1	000-067-2609-01	Consult
—	189088	Screw, mount, Phillips pan head, M2x4 SST	4	000-000-0067-00	Consult
503	171876	Photo interrupter trans, peel sensor, left, B13	1	000-112-1169-16	Consult
504	171877	Photo interrupter, trans, receive, peel sensor, right, B12	1	000-112-1170-11	Consult
601	172669	Sensor assy, label gap and head up, B10, B11, B15	1	100-002-3523-01	Consult
—	189088	Screw, mount, Cross-Head, M2x4, SST	2	—	Consult
602	172670	Harness, C2, thermal head (A10 XJ17 to E10 print head)	1	000-135-0319-23	Consult
603	182821	Harness, C2, sensor (B12 to X11)	1	100-002-3521-00	Consult
ASSY	171878	Stand by roller unit	1	100-006-8837-00	Consult
ASSY	172671	Roller assembly, assist		000-131-7350-08	Consult
ASSY	179113	Roller, stand by, short, assy (includes 2, 4, 5, 102, 103, 104)	2	100-006-8837-00	Consult

# Ishida WM-Ai

Printer Unit

Compatible with 105mm width label

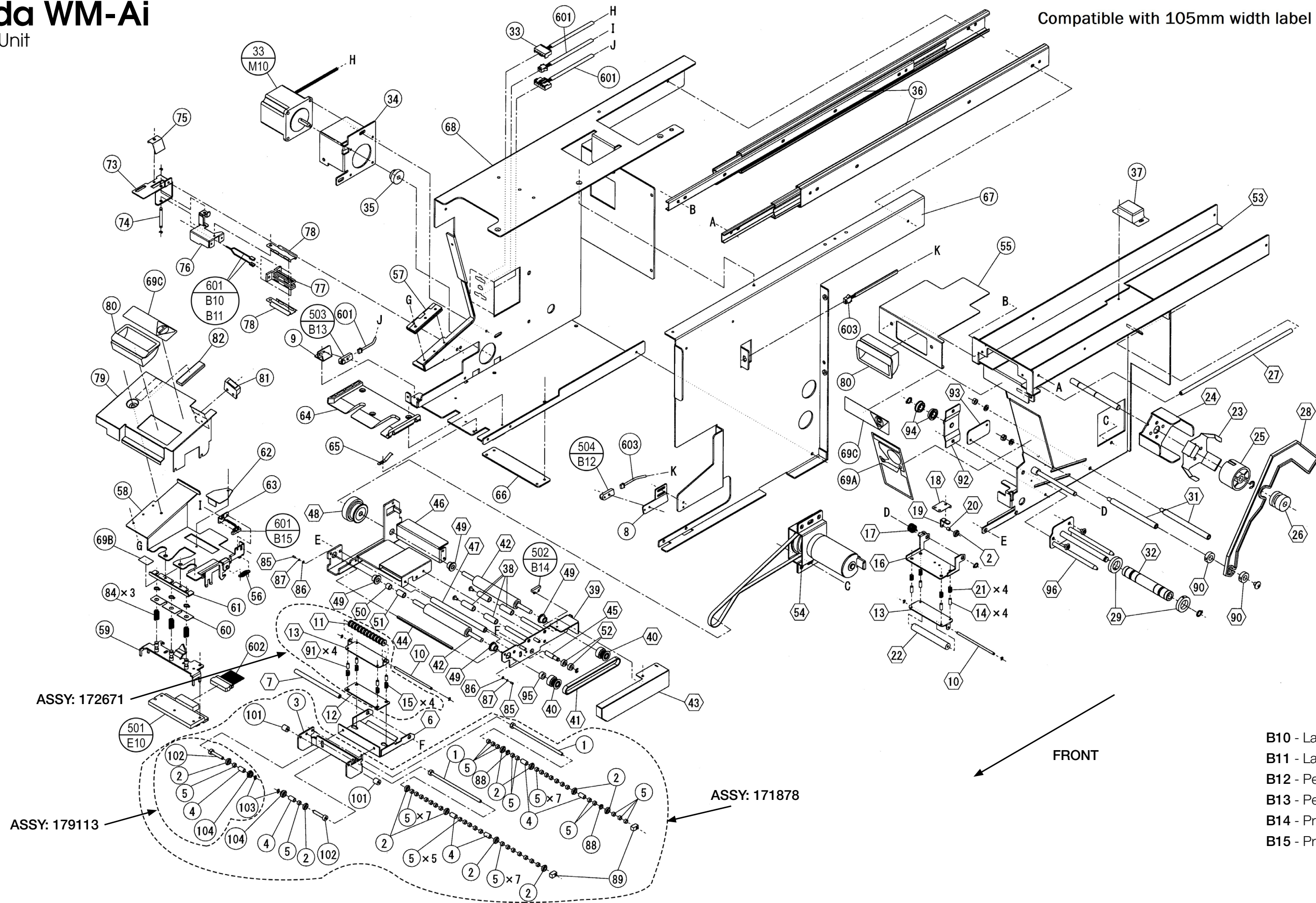

- B10 - Label gap sensor, emitter
- B11 - Label gap sensor, receiver
- B12 - Peel sensor, receiver
- B13 - Peel sensor, emitter
- B14 - Print head up magnet
- B15 - Print head up sensor