

Wrapping Unit

Part Number/Price

REF #	PART #	DESCRIPTION	QTY	SYNONYM	PRICE
1	157898	Shaft, step, R fold front	3	106-6925-22	Consult
2	157950	Holder, shaft	2	098-3131-06	Consult
3	Consult	Guide, tray	1	135-2551-38	Consult
4	Consult	Stay, discharge	1	135-2816-43	Consult
5	153650	Stay, heat insulation	2	135-2815-40	Consult
6	153651	Block A, heater	1	137-0620-48	Consult
7	153652	Collar A	1	096-0697-39	Consult
8	153653	Washer, thrust	2	073-7143-10	Consult
9	153654	Bush (included with #10)	2	070-5375-09	Consult
10	153655	Roller, rotation, heater (includes #9)	1	112-6814-04	Consult
11	153656	O-ring	2	015-8919-07	Consult
21	Consult	Frame, wrapper, rear	1	135-2860-48	Consult
22	Consult	Stay, frame, wrapping, front	1	135-2953-31	Consult
23	Consult	Stay, wrapping, front	1	143-3069-00	Consult
24	Consult	Shaft, fulcrum	1	135-2933-00	Consult
25	Consult	Bracket, pulley assy	1	135-2934-21	Consult
26	192102	Bearing, radial	2	001-6068-02	Consult
27	Consult	Timing pulley, S3M, A	1	138-5875-00	Consult
28	Consult	Timing pulley, XL	1	063-8346-04	Consult
29	45160	Collar, washer	1	002-8254-03	Consult
30	203251	Bearing, shaft	2	108-0297-39	Consult
31	172607	Pulley, tension	2	111-8488-03	Consult
32	171872	Timing belt, XL	1	108-0399-17	Consult
33	197526	Shaft, linear	2	098-8444-19	Consult
34	203252	Stay, fold R	1	135-2681-20	Consult
35	Consult	Holder, belt	1	135-2909-00	Consult
36	203254	Stay, fold L	1	135-2910-13	Consult
37	173743	Holder, belt	1	068-5090-25	Consult
38	161661	U plate B, detect	1	135-2911-35	Consult
39	167403	Housing, linear	4	057-0390-00	Consult
40	167404	Bearing liner bush	8	028-1515-01	Consult
41	Consult	Stay, linear shaft	1	135-2951-07	Consult
42	Consult	L plate B, R fold	1	135-2925-19	Consult
43	Consult	Rail, guide	1	135-2592-03	Consult
44	Consult	Block B, slide, pusher	2	111-8459-05	Consult
45	Consult	Housing, F, S	2	076-1759-04	Consult
46	157899	Bearing, linear bush	4	068-5132-00	Consult
47	157950	Holder, shaft	4	098-3131-06	Consult
49	Consult	Stay, drive, pusher	1	135-2928-10	Consult
50	Consult	Frame, pusher	1	144-5773-21	Consult
51	171609	Pusher, right, outside	2	144-5708-10	Consult
52	171610	Pusher, left, outside	2	144-5707-16	Consult
55	157847	Spring, coil, compressive	1	098-3135-01	Consult
56	157846	Shaft, lift, fix	1	101-1727-09	Consult
57	157844	Bracket, lift, fix	1	116-1863-08	Consult
58	157845	Plate, lift head	1	116-1864-01	Consult
59	198651	Collar, SST	2	112-6872-01	Consult
60	175680	Lever, drive	2	135-2958-30	Consult
61	Consult	Lever, drive	1	137-0648-23	Consult
62	125701	Solenoid, assy, arm in (closed) (L5, L6)	2	073-7078-01	Consult
63	125700	Solenoid assy, arm out (open) (L8)	1	111-8041-11	Consult
64	172652	Spring, coil, compressive	2	079-1005-20	Consult
65	175681	Collar, guard	3	096-7137-08	Consult
66	175682	Collar, step	3	098-0717-25	Consult

Wrapping Unit

Part Number/Price

REF #	PART #	DESCRIPTION	QTY	SYNONYM	PRICE
67	175684	Bearing, radial	3	000-3694-06	Consult
69	Consult	Bracket, motor, stepping	1	135-2932-15	Consult
70	203918	Timing pulley, S3M C	1	138-5877-07	Consult
71	163309	Timing belt, S3M	1	138-5879-04	Consult
72	187475	Collar A	4	095-9235-00	Consult
73	Consult	Tray hold assy	1	142-1864-00	Consult
74	Consult	Plate B, guide, tray	1	142-1861-09	Consult
75	Consult	U plate A, tray hold	1	142-1863-06	Consult
76	Consult	Bracket, sensor, back fold	1	143-3076-06	Consult
81	Consult	Frame, wrapping, side right	1	135-2858-31	Consult
82	Consult	Frame, wrapping, side left	1	135-2861-41	Consult
83	171669	Folder, side, right, wrap plate	1	144-5972-08	Consult
--	167297	Hex socket bolt, counter sink, M4x10 SST	8	048-0483-01	Consult
84	171670	Folder, side, left, wrap plate	1	144-5973-01	Consult
85	Consult	Shaft, linear	2	135-2919-07	Consult
86	Consult	Joint, drive, fold	1	135-2921-41	Consult
88	Consult	Joint, drive, pusher	1	135-2926-12	Consult
89	125714	Motor assy, stepping, side folders (M3)	1	137-0538-18	Consult
90	Consult	Bracket, solenoid	1	135-2956-14	Consult
91	186769	Bush, front frame	2	031-9453-01	Consult
92	Consult	Collar	1	059-1079-09	Consult
93	Consult	Stopper, arm, front, inside	1	138-2259-04	Consult
94	Consult	Stopper, arm, rear, inside	1	138-2260-09	Consult
95	171611	Pusher, right, center	1	144-5711-11	Consult
96	171612	Pusher, left, center	1	144-5710-18	Consult
97	171613	Pusher, right, inside	1	144-5705-19	Consult
98	171614	Pusher, left, inside	1	144-5701-14	Consult
101	Consult	Stay, guide, safety	1	135-2954-17	Consult
102	Consult	Guard, safety	1	135-2952-29	Consult
103	197169	Stopper, arm, outside	2	135-2930-09	Consult
105	197170	Cover, belt	1	137-0657-09	Consult
106	193531	Bracket, sensor, left	1	137-8056-19	Consult
107	193532	Bracket, sensor	2	138-2265-07	Consult
110	Consult	Bracket, sensor, light	1	141-6055-04	Consult
113	189254	Sheet, sensor photo	2	095-4038-04	Consult
114	Consult	Detect plate, back fold	3	143-3075-11	Consult
115	Consult	Cover, wrapping inner, right	1	000-142-6124-14	Consult
116	Consult	Cover, wrapping inner, left	1	000-142-6125-18	Consult
501	153657	Thermistor assy, for seal bar (R1), 3.1K ohm	1	072-2291-03	Consult
502	153658	Heater assy, seal bar (E2), 133 ohm	1	137-0612-01	Consult
504	125711	Photo interruptor, sensor, transmitter, safety and tray exit (B4, B5) Note: transmit sensor does not include item #113 189254 sheet, sensor which is needed at B4	2	112-9768-07	Consult
505	125712	Photo interruptor, sensor, receive, safety and tray exit (B7, B8)	2	112-9769-01	Consult
ASSY	201989	Kit, photo interruptors and sensor sheet, one each of 125711, 125712 and 189254	—	—	Consult
506	104239	Photo interruptor, transmitter, L/R wrap-home, rear wrap-limit, and film arm-open, white conn. (B2, B11, B16)	3	070-5204-14	Consult
508	125710	Sensor assy, magnetic, proximity, green, left door (B12)	1	137-0521-15	Consult
—	189088	Screw, mount, Phillips pan head, M2x4 SST	2	000-000-0067-00	Consult
509	125709	Sensor assy, magnetic, proximity, green, right door (B13)	1	137-0522-19	Consult
—	189088	Screw, mount, Cross-Head, M2x4, SST	4	—	Consult
602	Consult	Accessory, band, marking	1	135-0341-08	Consult
603*	Consult	Harness, C4, solenoid (X2 to L5, L6 and L7)	1	135-0159-24	Consult
604*	169974	Harness, C2, ST motor (P-1006 A2 XJ4 to M3)	1	135-0163-11	Consult
605*	210885	Harness, C4, sensor (X4 to B4, B5, and B13)	1	132-2005-48	Consult
606*	210886	Harness, C5, sensor (X3 to B2, B7, B8, and B11)	1	135-0158-49	Consult
607*	210887	Harness, C2, sensor (X5 to B16)	1	143-0923-00	Consult
	200488	Screw set M4x6			Consult
	173777	Screw set M6-1.0 x 8 mm			Consult

* See the [WM-Nano Wiring Diagrams on page 161](#) and [page 162](#): items 3-603 to 3-607

Ishida WM-Nano

Wrapping Unit

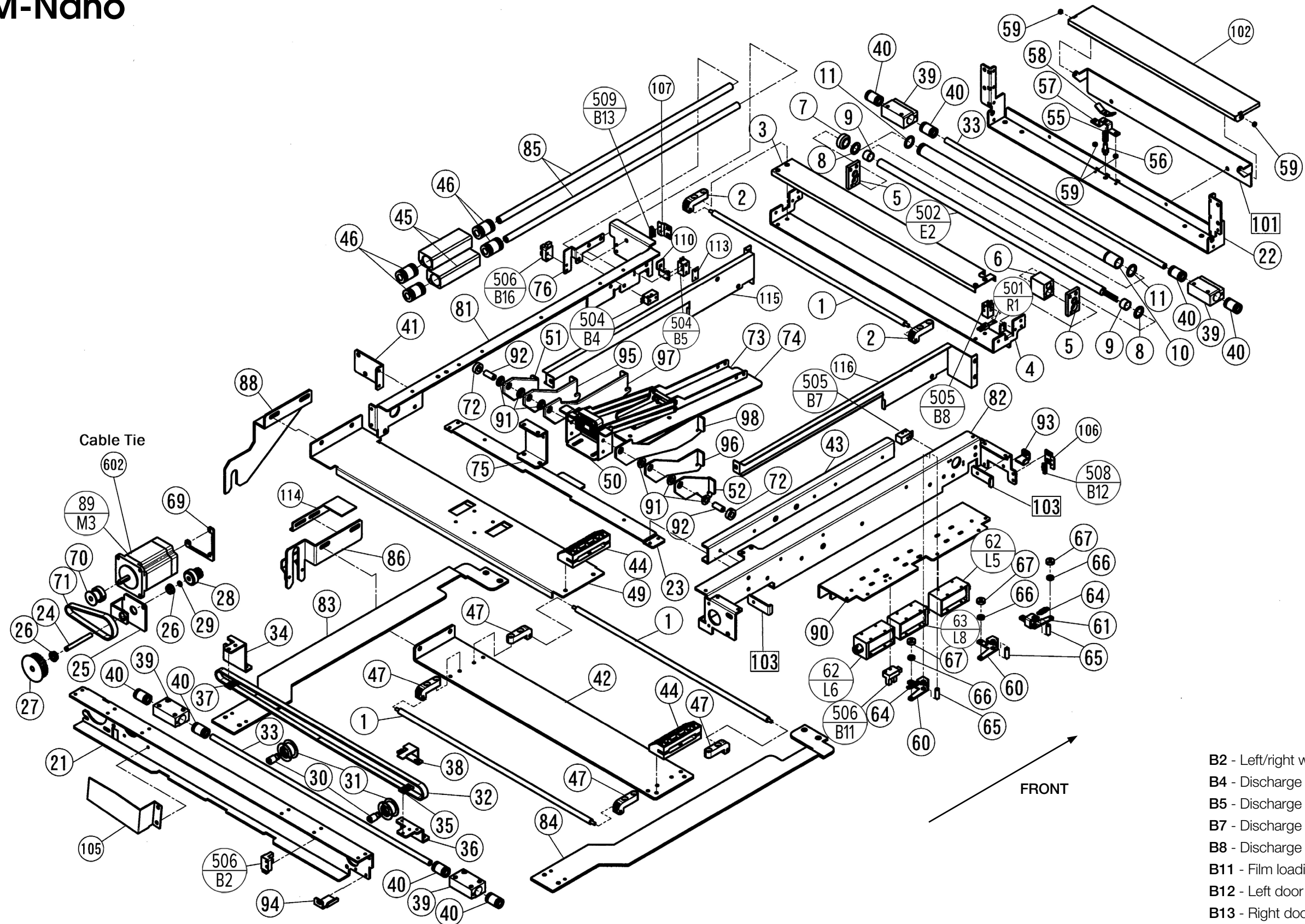

- B2 - Left/right wrap plates home position
- B4 - Discharge safety, transmitter
- B5 - Discharge tray detect, transmitter
- B7 - Discharge safety, receiver
- B8 - Discharge tray detect, receiver
- B11 - Film loading arm open/closed
- B12 - Left door open/closed
- B13 - Right door open/closed
- B16 - Rear wrap plate front limit position