

iDimension® Plus XL

Single and Dual Arm Stands

The iDimension Plus XL Single and Dual Arm Stands are designed to be installed directly over a conveyor or work table. Consult with the factory on the mounting height to ensure best performance.



Note *Scanning heads are not included with the iDimension Plus XL Single or Dual Arm Stands.*

Mount the heads at 79" (2000 mm) or 60.2" (1529 mm) above the platform base. The stands are adjustable vertically and horizontally to work in conjunction with most conveyor or tabletop applications.

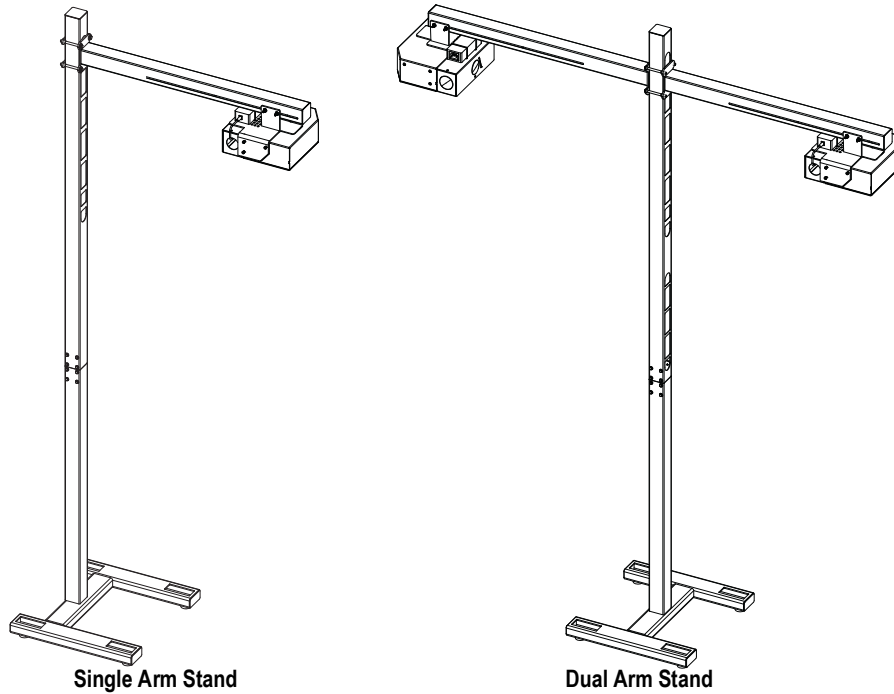

Figure 1. Single (PN 174660) and Dual (PN 182195) Arm Stands

Assembly

See the following information for iDimension Plus XL Single and Dual Arm Stands assembly instructions:

1. Unpack the contents of crate. See the placement parts list to confirm that all of the parts are included in the crate.
2. Assemble the iDimension Plus XL head assembly from using the iDimension Plus Assembly Instructions (PN 198810).
3. Lay the stand base (1) on the floor and screw in the four adjustable stand feet (3) into the bottom of the stand base.
4. Tip the stand back up.



Note Do not screw in the stand feet if the stand is being bolted to the floor.

5. Level stand base by adjusting the four feet (3) with a flathead screwdriver.
6. Secure the two joint plates (7) to the inside of the upper portion of the stand base tube using four 1/4-20 x 3/4" bolts (8) and four 1/4" washers (9) for each joint plate.

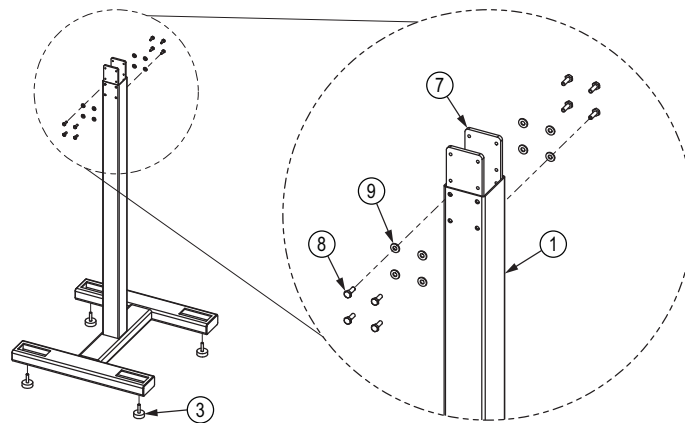

Figure 2. Initial Base Assembly

7. Slide the upright tube (2) over the joint plates.
8. Line up the bolt holes.
9. Rest the upright tube on the stand base tube (1).
10. Secure the upright tube with 1/4-20 x 3/4" bolts (8) and 1/4" washers (9).

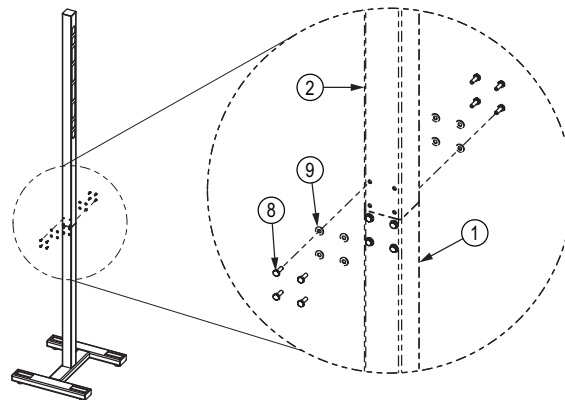
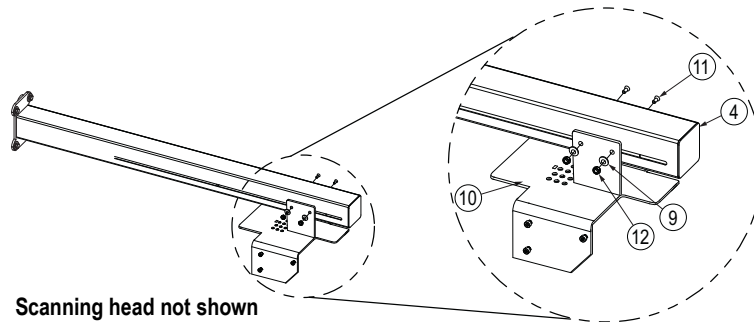

Figure 3. Upright Tube Attachment

11. Place the horizontal arm(s) (4) on a flat surface with the open side face up. Attach the scanning head (10) using four 1/4-20 x 1" carriage bolts (11), four 1/4" washers (9) and four nuts (12).



Scanning head not shown

Figure 4. Head Mount Attachment to Horizontal Arm(s)



Note Attaching the horizontal arm(s) is recommended to be done by two people.

12. Lay the stand down and attach the horizontal arm(s) (4) to the upright tube with four 3/8-16 x 4" bolts (5), four 3/8" washers (6) and two threaded plates (13) or the second horizontal arm (13).

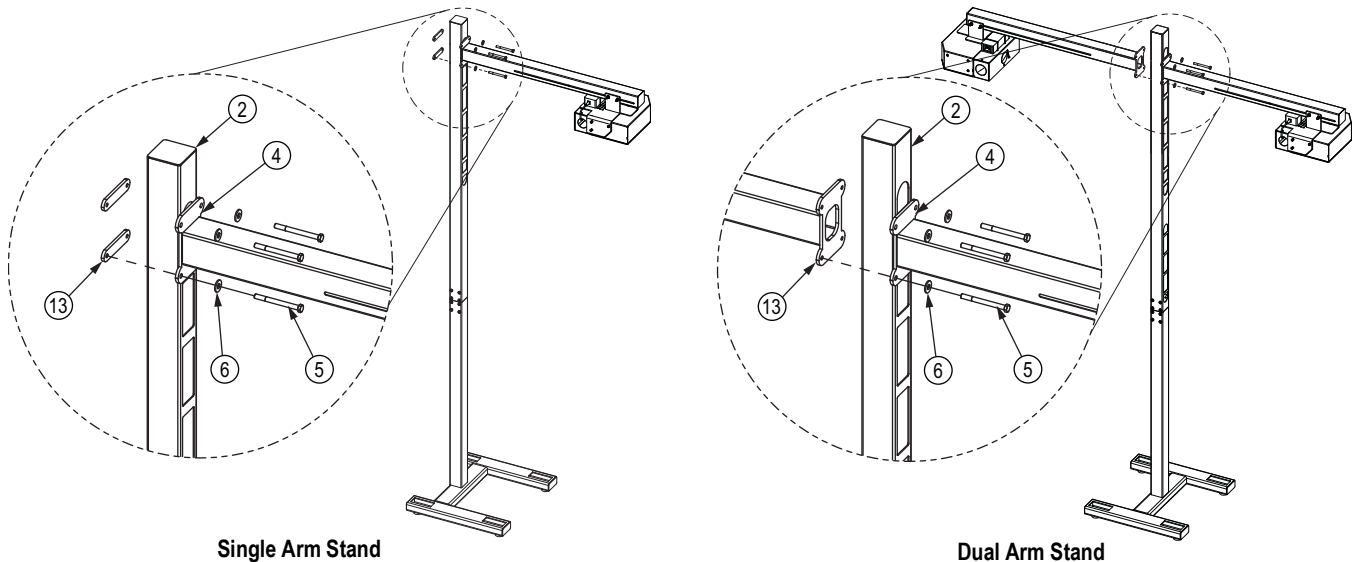

Single Arm Stand

Dual Arm Stand

Figure 5. Single (PN 174660) and Dual (PN 182195) Stand Arm Horizontal Arm Attachment

13. Tilt the stand back up and ensure the stand is secure.
14. Route scanning head cable assembly (10) through horizontal arm and pole assembly as needed.



Note Make vertical adjustments to horizontal arm(s) and horizontal adjustments to head mount(s) when stand is in position. Measure the height of the platform base (conveyor or tabletop) and add 79" (2000 mm) or 60.2" (1529 mm) to calculate the height of the horizontal arm(s), based on the head height. Confirm that the stand base is level and make foot adjustments if needed.

Replacement Parts

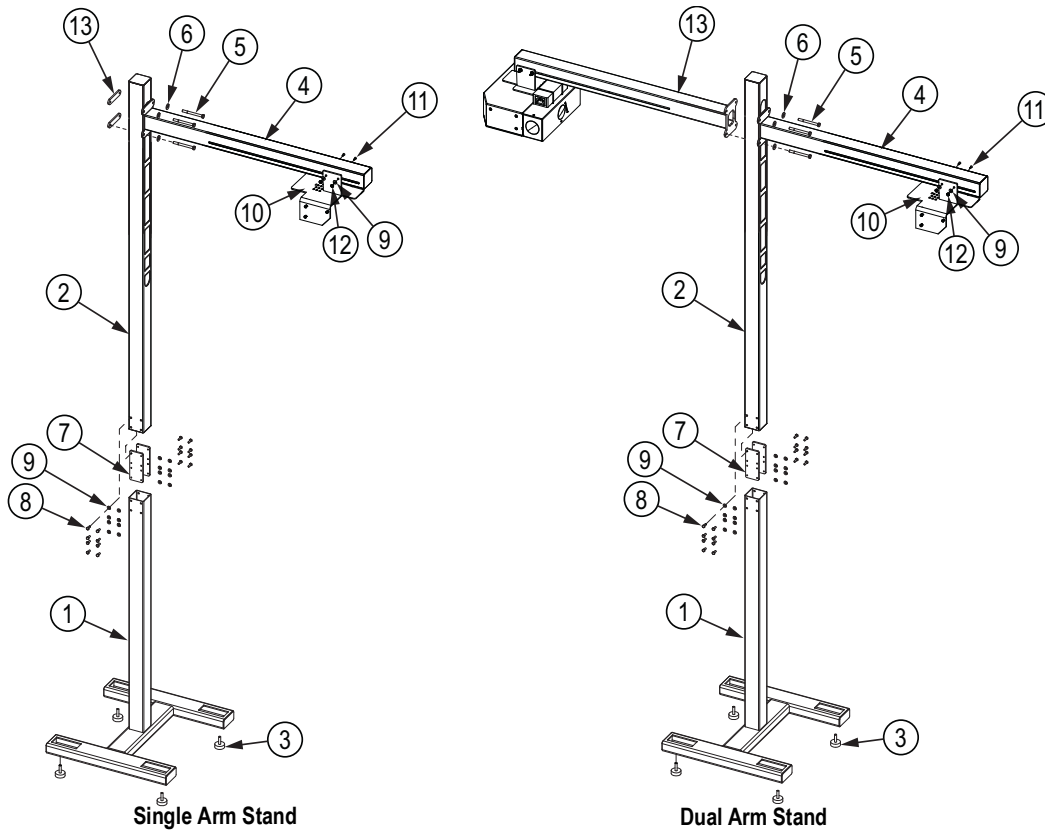

Figure 6. Single (PN 174660) and Dual (PN 182195) Stand Replacement Parts

Item No.	Part No.	Description	Qty.
1	182269	Single Arm Stand Base	1
2	182219	Upright Tube	1
3	181667	Leveling Foot, 3/8-16	4
4	182188	Horizontal Arm	1
5	127003	3/8-16 x 4, Hex Bolt	4
6	21938	3/8 Type A, Plain Washer	4
7	182193	Joint Plate	2
8	14963	1/4-20 x 3/4, Hex Head Cap Screw	16
9	15145	1/4 Type A, Plain Washer	20
10	198567	iDimension Plus XL Camera Mount	1
11	132917	1/4-20 x 1, Carriage Bolt	4
12	14641	1/4-20, Steel Hex Nut	4
13	182270	Threaded Plate	2

Table 1. Single Arm Stand Replacement Parts (PN 174660)

Item No.	Part No.	Description	Qty.
1	182186	Dual Arm Stand Base	1
2	182219	Upright Tube	1
3	181667	Leveling Foot, 3/8-16	4
4	182188	Horizontal Arm	1
5	127003	3/8-16 x 4, Hex Bolt	4
6	21938	3/8 Type A, Plain Washer	4
7	182193	Joint Plate	2
8	14963	1/4-20 x 3/4, Hex Head Cap Screw	16
9	15145	1/4 Type A, Plain Washer	24
10	198567	iDimension Plus XL Camera Mount	2
11	132917	1/4-20 x 1, Carriage Bolt	8
12	14641	1/4-20, Steel Hex Nut	8
13	182189	Horizontal Arm, Threaded	1

Table 1. Dual Arm Stand Replacement Parts (PN 182195)

Display Mount Kit Option (PN 184262)

- Secure the mount plate (1) to the upright tube of stand using two clamp mounts (2), four 1/4-20 x 3.5" cap screws (3), and four lock washers (4).
 - Positioned the arm stand height torque to 8 ft/lb
- Attach a Ram Mount® base (6) to the studs of the mount plate (1) using four 1/4-20 nuts (5) and four lock washers (4).
- Attach second Ram Mount base (6) to the USB display (not included with the Ram Mount kit) using the four M4 screws and four flat washers.
- Connect the Ram Mount bases to each other using the Ram Mount arm (7).
- Position display at intended angle and secure in place by tightening the hand knob on the Ram Mount arm.

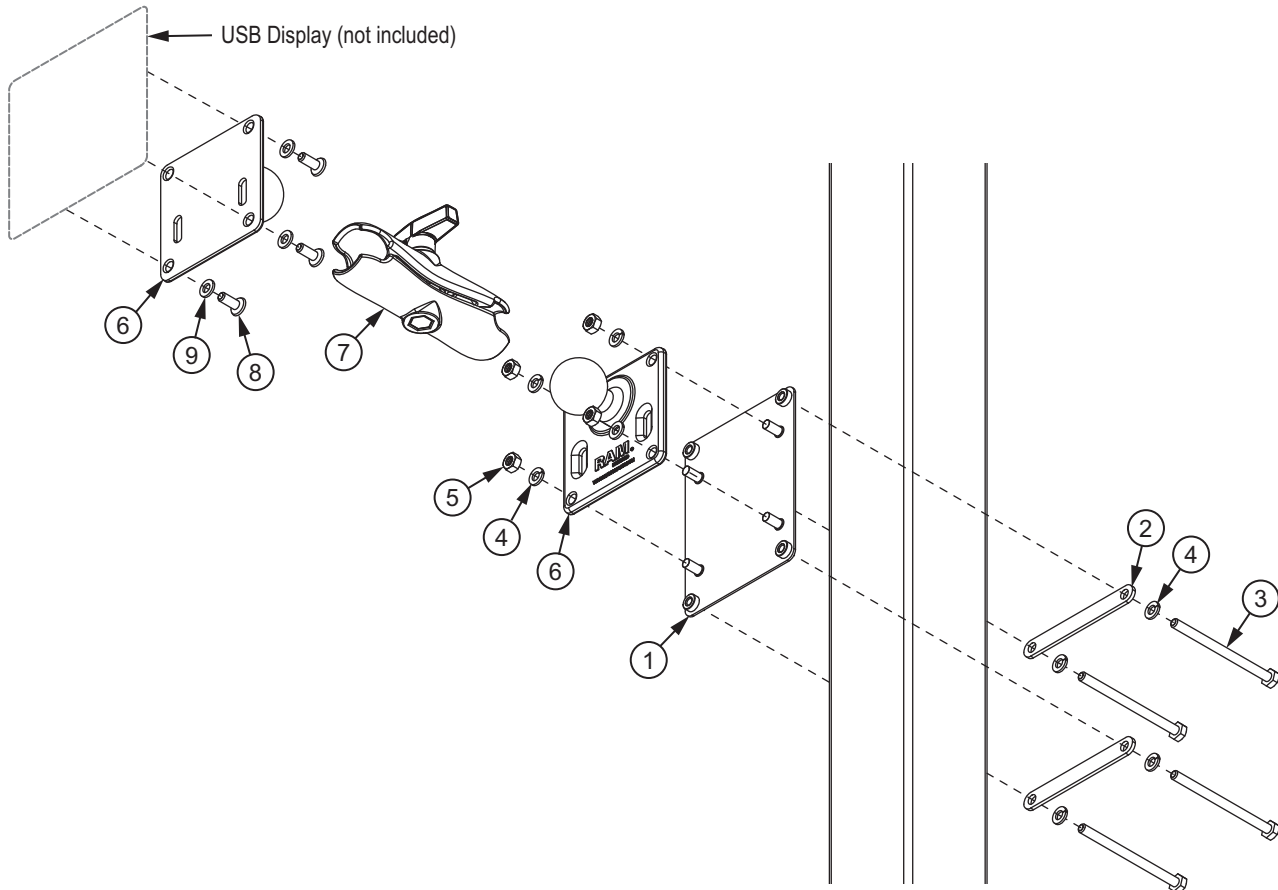

Figure 7. Display Mount Attachment

Item No.	Part No.	Description	Qty.
1	184307	Mount Plate	1
2	184325	Clamp Plate	2
3	126933	1/4-20 x 3.5" Hex Head Cap Screw	4
4	15147	1/4" Lock Washer	8
5	14641	1/4-20 Hex Nut	4
6	175508	Ram Mount Base	2
7	175509	Ram Mount Arm	1
8	166216	M4 x 12 mm Phillips Pan Head Screw	4
9	179971	M4 x 9 mm Flat Washer	4

Table 2. Display Mount Kit



© Rice Lake Weighing Systems Specifications subject to change without notice.
Rice Lake Weighing Systems is an ISO 9001 registered company.

230 W. Coleman St. • Rice Lake, WI 54868 • USA
U.S. 800-472-6703 • Canada/Mexico 800-321-6703 • International 715-234-9171 • Europe +31 (0)26 472 1319